

**Existing / Demolition Floor Plan**

SCALE: 1/4"=1'-0"

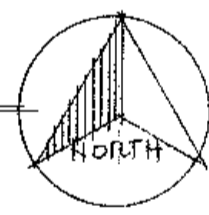

- \* REMOVE ANY MISC. ITEMS AS REQUIRED TO FACILITATE NEW WORK.
- \* INTERIOR ELECTRONIC SECURITY GATES SHALL BE RELOCATED BY OWNER'S VENDOR, G.C. TO CO-ORDINATE.

**Floor Plan Notes**

- 1 EXISTING BRICK PILASTERS TO REMAIN
- 2 EXISTING STEEL LINTEL 14'-9" AFF WITH MASONRY ABOVE, TO REMAIN.
- 3 EXISTING STEEL LINTEL 7'-4" AFF WITH MASONRY ABOVE, TO REMAIN.
- 4 EXISTING SPIRAL DUCT ABOVE, TO REMAIN
- 5 EXISTING WOOD RAIL TO REMAIN
- 6 EXISTING BRICK WALL TO REMAIN
- 7 REMOVE EXISTING CARPET IN EXISTING LOBBY
- 8 REMOVE EXISTING WALL LIGHTS
- 9 REMOVE EXISTING CABINET HEATER AND THERMOSTAT. UNIT IS DISCONNECTED AND NOT OPERATIONAL.
- 10 EXISTING CAMERA TO BE REMOVED AND RELOCATED BY OWNER'S VENDOR.
- 11 EXISTING BRONZE PLAQUE TO BE REMOVED, GIVE TO OWNER
- 12 EXISTING FIRE ALARM PANEL TO BE REPOSITIONED BY OWNER'S VENDOR.
- 13 REMOVE EXISTING DRYWALL CEILING ABOVE EXISTING VESTIBULE
- 14 REMOVE EXISTING ALUMINUM STOREFRONT FRAMING, DOORS, SKYLIGHT FRAMING AND GLAZING
- 15 REPLACE EXISTING EXTERIOR WALL MOUNT LIGHTS WITH NEW, REPAIR BRICK TO MATCH EXISTING, IF NECESSARY, (ALT. BID ITEM #E-1)
- 16 EXISTING EXTERIOR BRICK MASONRY WALLS TO REMAIN AS IS.
- 17 EXISTING CONCRETE ENTRANCE WALK TO REMAIN AS IS, REPAIR AS NECESSARY TO FACILITATE NEW PLUMBING WORK.
- 18 EXISTING LOW BRICK WALL TO REMAIN AS IS.

**Drawing Index**

- A-1. EXISTING / DEMOLITION FLOOR PLAN / CODE COMPLIANCE NOTES
  - A-2. RENOVATION FLOOR PLAN / INTERIOR ELEVATIONS
  - A-3. BUILDING CROSS-SECTIONS
  - A-4. EXTERIOR ELEVATION / DOOR & HARDWARE SCHEDULE
  - A-5. ROOM FINISH NOTES / ALTERNATE BID ITEM #1
  - M-1. MECHANICAL PLAN
  - E-1. ELECTRICAL PLAN / NOTES
  - E-2. ELECTRICAL ALTERNATE #E-1 / NOTES
- \* EXISTING PLUMBING / MECHANICAL DRAWINGS ATTACHED FOR REFERENCE (P-1/P-2/P-3/M-2)

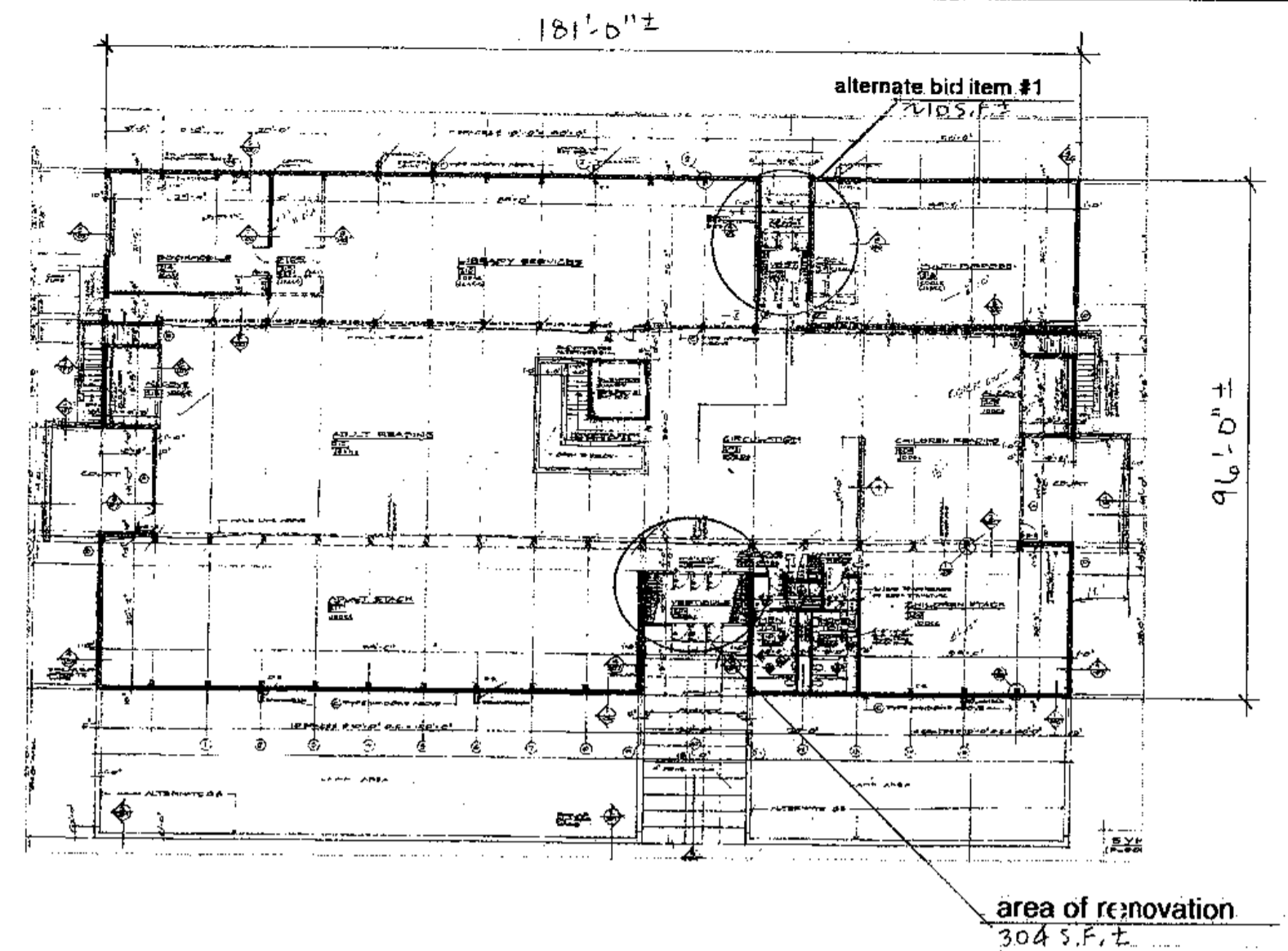

**Existing Overall Floor Plan**

NOT TO SCALE

area of renovation  
304 S.F.

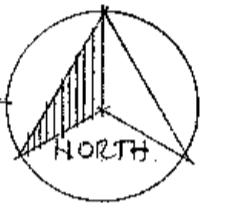

**Code Compliance Notes - 2011 OBC**

**SCOPE OF WORK:**

Remove existing storefront structure at south entrance / rebuild entrance within existing footprint. Construct a new handicapped single user toilet room within existing vestibule for the convenience of the library patrons. Area of alteration is approximately 304 square feet.

**CODE COMPLIANCE DATA:**

\*\* Section 3404.1...alterations to any building or structure shall comply with the requirements of the code for new construction to the extent of the alteration. Alterations shall be such that the existing building or structure is no less complying with the provisions of the code than the existing building or structure was prior to the alteration.

**EXISTING BUILDING DATA:**

Existing Occupancy Classification (303.1) - Library (A-3)

Construction Type: 3B, masonry bearing walls / wood roof structure / basement and, concrete slab on grade

Area of Alteration: 304 square feet

- \*\* all new work shall comply with all applicable OSHA requirements
- \*\* all new work shall comply with ANSI A117.1 accessibility standards
- \*\* all new interior finishes shall comply with Chapter 8 of the OBC

7-29-16 ISSUED FOR PERMIT/BIDS

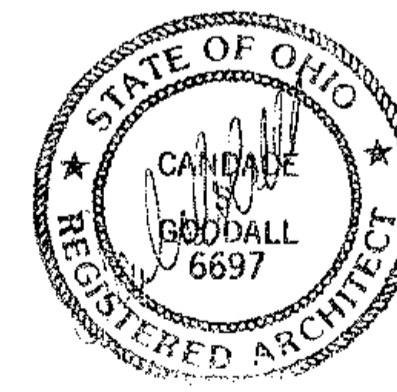

**CANDACE GOODALL**  
ARCHITECT

Commercial  
Residential  
Multi-Family

211 Finsbury Lane  
Troy, Ohio 45373  
(937) 335-1579  
cg.arch@earthlink.net

SOUTH ENTRANCE RENOVATIONS		
<b>Troy - Miami County Public Library</b>		
SCALE:	APPROVED BY:	DRAWN BY: CANDY GOODALL
DATE: JULY 29, 2016		REVISED:
419 WEST MAIN STREET		TROY, OHIO 45373
PROJECT # 2015-04		DRAWING NUMBER
		<b>A-1</b> OF 8

Candace Goodall, License #8006697  
Expiration Date: 12/31/17

\* CONTRACTOR'S SHALL VERIFY ALL EXISTING FIELD CONDITIONS AND DIMENSIONS!

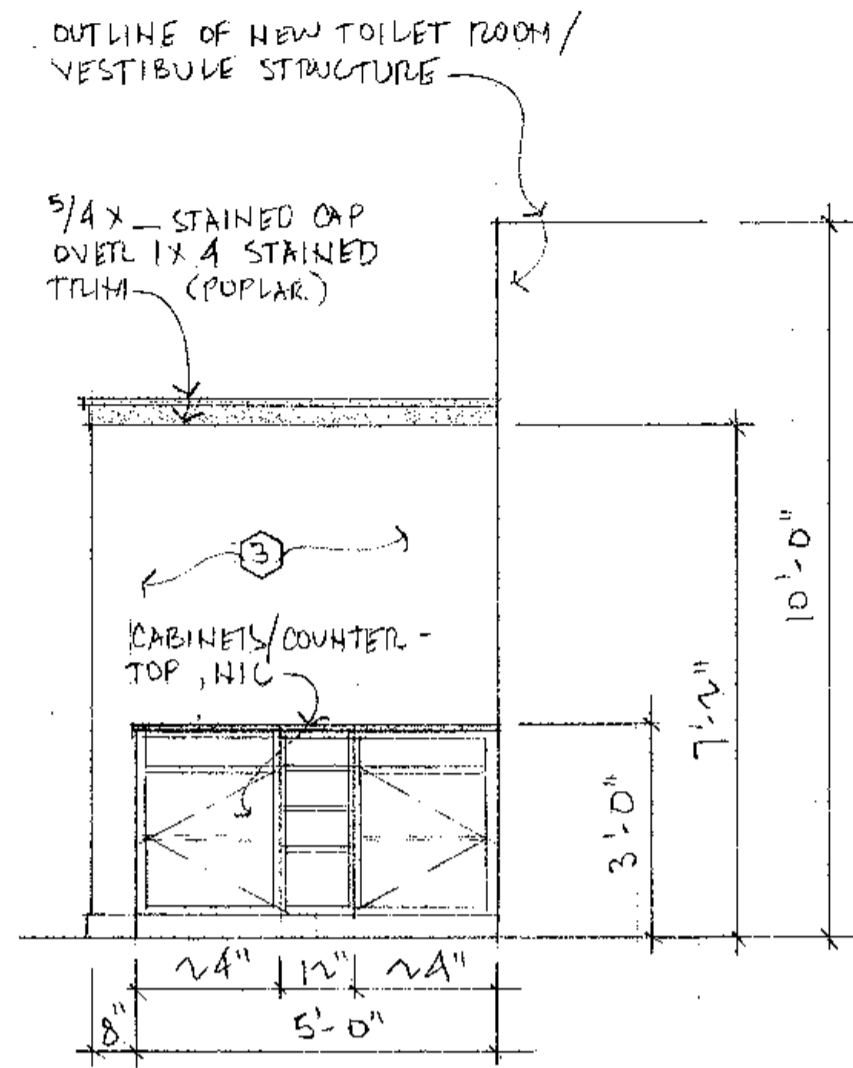
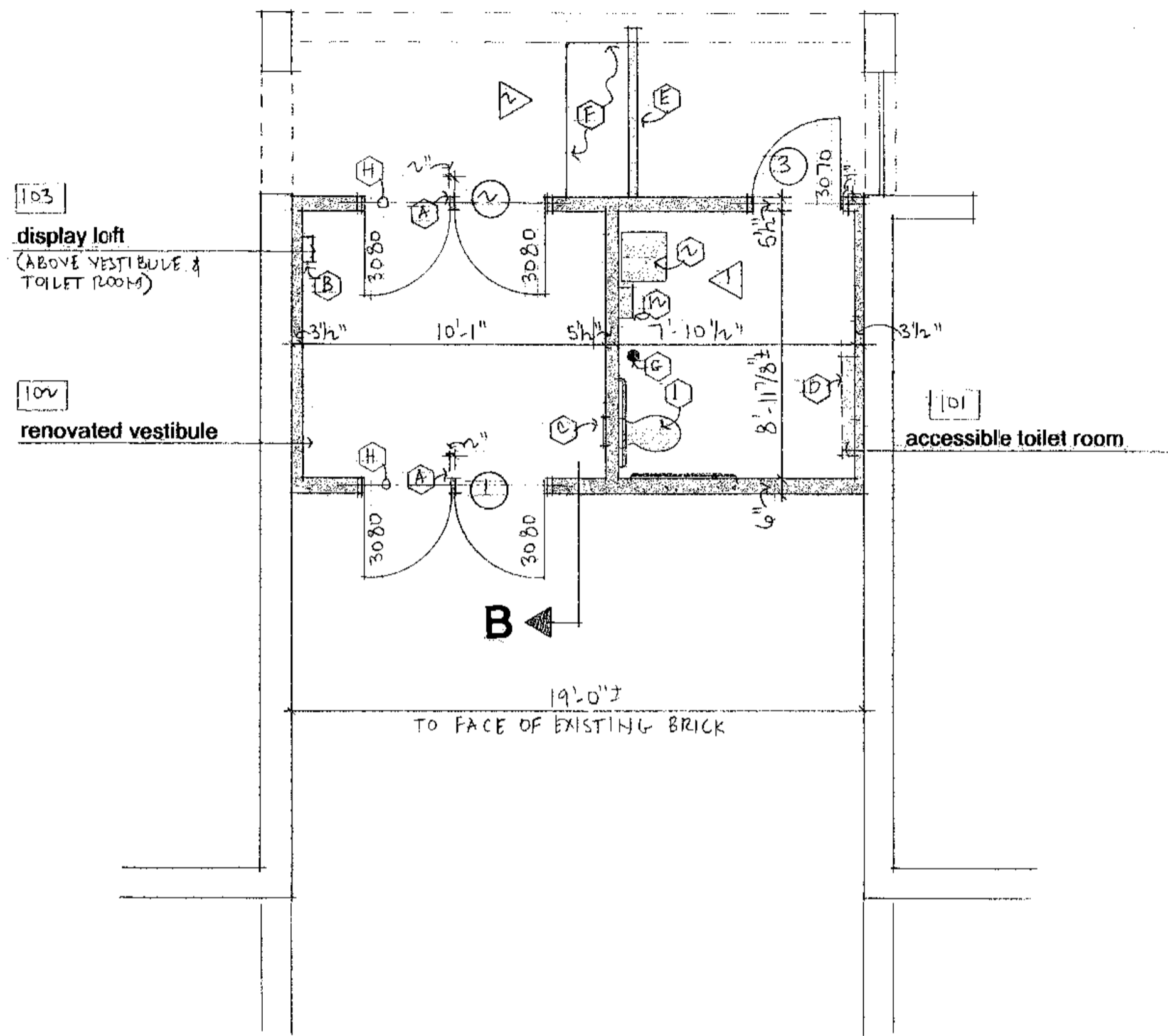

**2 Coffee Counter Elevation**  
SCALE: 3/8" = 1'-0"

\* PROVIDE BLOCKING FOR FUTURE CABINETS/COUNTERTOP.

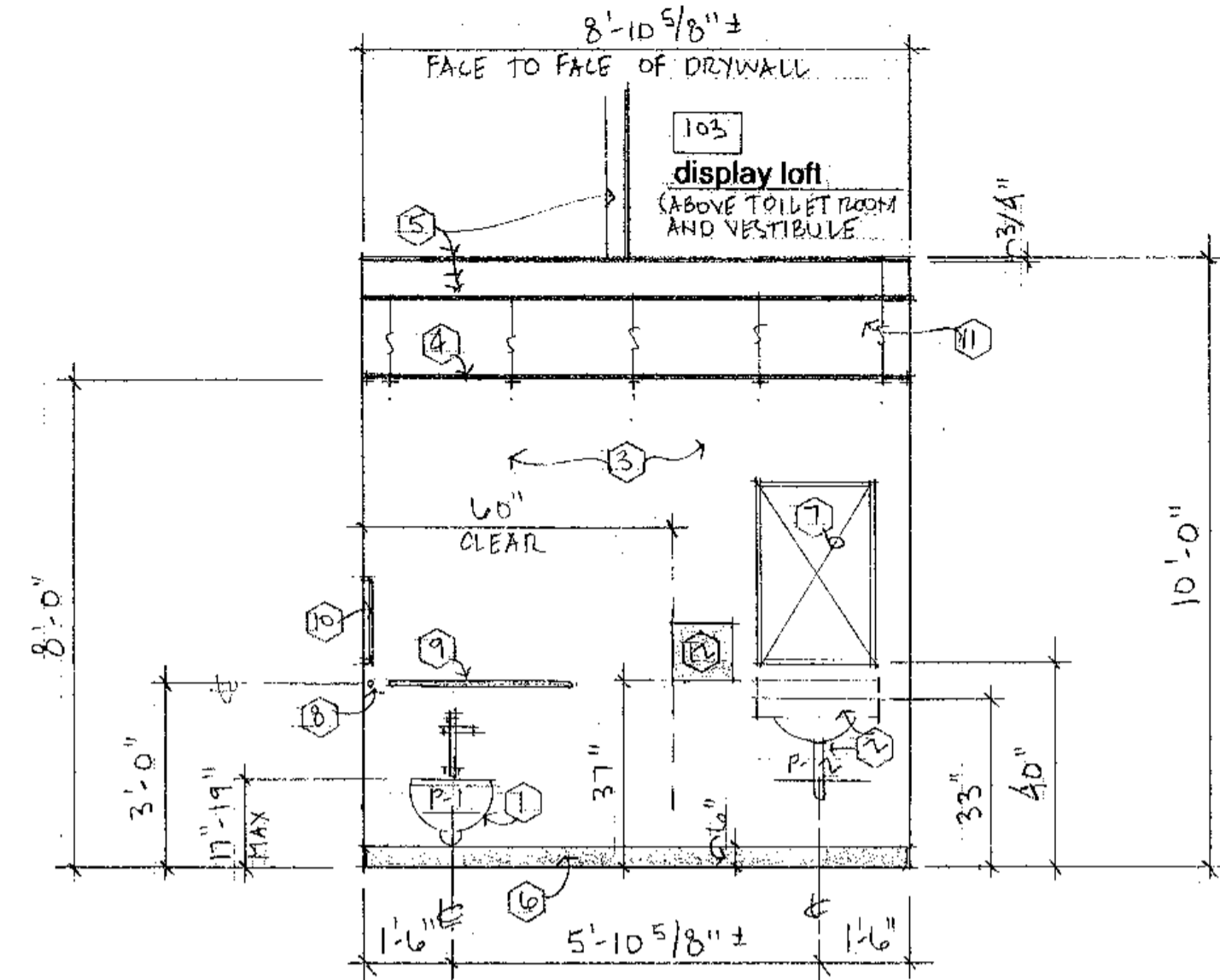

**1 Toilet Room Elevation**  
SCALE: 3/8" = 1'-0"

- 1 ADA COMPLIANT WALL HUNG WATER CLOSET WITH FLUSH HANDLE ON SIDE FARTHEST FROM WALL.
- 2 ADA COMPLIANT WALL HUNG CHINA LAVATORY, INSULATE EXPOSED PIPES BELOW.
- 3 WATER RESISTANT, PAINTED DRYWALL.
- 4 SUSPENDED ACOUSTICAL CEILING.
- 5 SEE BUILDING CROSS-SECTION B/B FOR DETAILS OF STRUCTURE ABOVE.
- 6 6" HIGH 'KEY RESIN', INTEGRAL COVE BASE
- 7 PLATE GLASS MIRROR WITH BEVELED EDGE.
- 8 4" GRAB BAR - 'BOBRICK' #B6806, OR EQUAL
- 9 36" GRAB BAR - 'BOBRICK' #B6806, OR EQUAL
- 10 .18" VERTICAL GRAB BAR - 'BOBRICK' #B6806, OR EQUAL, 39"-41" FROM REAR WALL AND 39"-41" FROM FINISH FLOOR LINE.
- 11 EXTEND DRYWALL TO BOTTOM OF STRUCTURE ABOVE, TYPICAL ALL NEW WALLS.
- 12 ELECTRIC HAND DRYER, 'XLERATOR' #XL-GR; GRAPHITE, SURFACE MOUNTED, ADA COMPLIANT.

TOILET ROOM ACCESSORIES:  
TOILET PAPER HOLDERS, SOAP DISPENSERS, TRASH RECEPTACLES, MISC. TOILET ROOM ACCESSORIES, SHALL BE PROVIDED BY OWNER'S VENDOR. GENERAL CONTRACTOR SHALL INSTALL DEVICES AND PROVIDE ALL BLOCKING, ALL DEVICES TO BE MOUNTED PER ADA REG. REGULATIONS.

**Floor Plan**

SCALE: 1/4" = 1'-0"

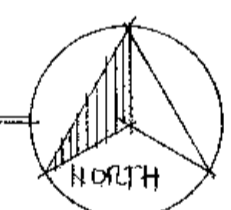

- A REMOVABLE ASTRAGAL
- B RELOCATED FIRE ALARM CONTROL PANEL (BY OWNER'S VENDOR).
- C LOCKABLE, PLUMBING ACCESS PANEL
- D BABY CHANGING STATION, 'KOALA CARE', OR EQUAL, #KB200 HORIZONTAL WALL MOUNTED, COLOR: #105, 'WHITE GRANITE'.
- E LOW WALL WITH WOOD CAP, SEE INTERIOR ELEVATION #2, THIS SHEET.
- F OUTLINE OF FUTURE CABINETS/COUNTERTOP, PROVIDE BLOCKING IN WALL.
- G FLOOR DRAIN
- H HEADER ABOVE NEW OPENINGS, 3-2x10<sup>3</sup>

**Legend**

- EXISTING CONSTRUCTION TO REMAIN
- NEW INTERIOR PARTITION 2x4's / 2x6's, 1/2" INSULATED 5/8" PAINTED DRYWALL BOTH SIDES.
- NEW EXTERIOR WALL 2x6's, 1/2" INSULATED 5/8" DRYWALL INSIDE, 1/2" EXTERIOR PLYWOOD ON OUTER FACE.

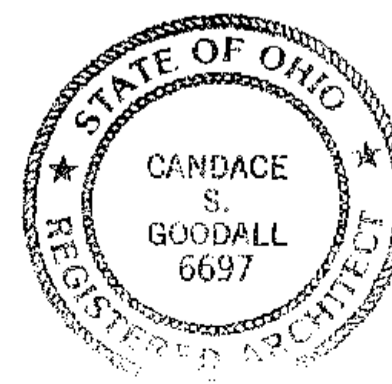

**CANDACE GOODALL**  
ARCHITECT  
211 Finsbury Lane  
Troy, Ohio 45373  
937) 335-1579  
cg.arch@earthlink.net

7-29-16 ISSUED FOR PERMITS / BIDS

SOUTH ENTRANCE RENOVATIONS		
Troy - Miami County Public Library		
SCALE:	APPROVED BY:	DRAWN BY: CANDY GOODALL
DATE: JULY 29, 2016		REVISED:
419 WEST MAIN STREET		TROY, OHIO 45373
PROJECT #2015-04		DRAWING NUMBER <b>A-2</b> OF 8

\* CONTRACTOR'S SHALL VERIFY ALL EXISTING FIELD CONDITIONS AND DIMENSIONS!

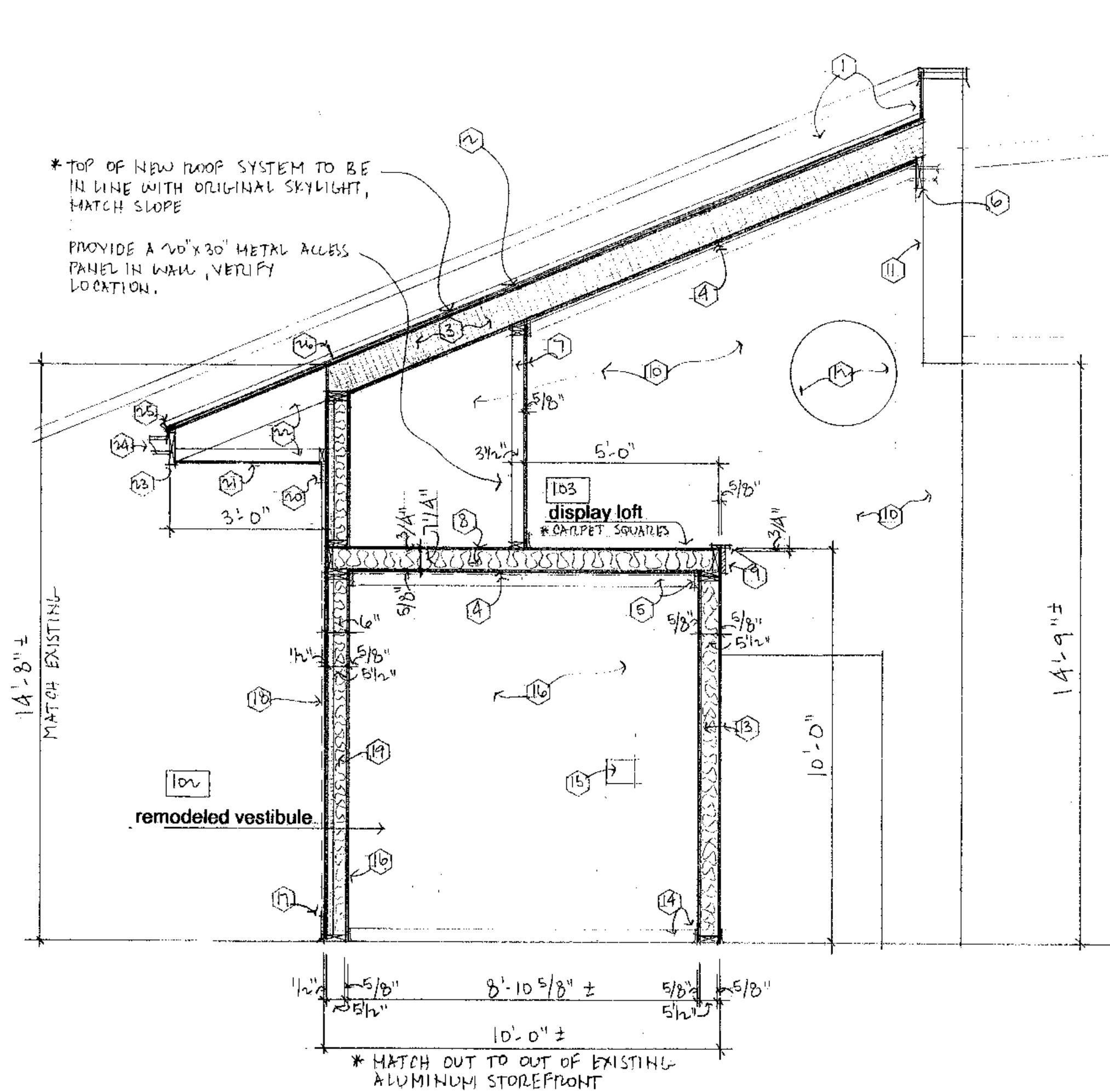

**Building Cross Section B - B**

SCALE: 3/8" = 1'-0"

- 1 FLASH INTO EXISTING COPING
- 2 NEW STANDING SEAM METAL ROOF PANELS OVER 1/2" RAPTOR SYNTHETIC UNDERLAYMENT OVER 5/8" EXTERIOR GRADE PLYWOOD SHEATHING, SEE EXTERIOR ELEVATION FOR FULL ROOF SPECIFICATION.
- 3 2 x 10<sup>s</sup>, 16" g/c WITH CLOSED CELL SPRAY FOAM INSULATION BETWEEN (FILL CAVITY) R=60 ±
- 4 8" WIDE #116 T & G, GROOVED BARN SIDING, STAINED OVER 5/8" DRYWALL
- 5 1 x 4, CLEAR POPLAR, STAINED, AT PERIMETER
- 6 TREATED 2 x 10 LEDGER BOARD, ANCHOR TO EXISTING MASONRY WALL WITH 3/4" φ EXPANSION BOLTS 2'-0" g/c STAGGERED
- 7 5/8" PAINTED DRYWALL OVER WOOD STUDS 16" g/c
- 8 3/4" T & G PLYWOOD SHEATHING OVER 2 x 8<sup>s</sup>, 16" g/c WITH FIBERGLASS BATT INSULATION BETWEEN LOFT FLOOR IS DESIGNED FOR 100PSF (L.L. + D.L.)
- 9 1 x 6 OVER 1 x 8, STAINED POPLAR
- 10 EXISTING BRICK TO REMAIN EXPOSED, REPLACE ANY UNITS DAMAGED DUE TO CONSTRUCTION.
- 11 PAINT EXISTING CONCRETE BLOCK & LEDGER BOARD
- 12 EXISTING SPIRAL DUCT TO REMAIN
- 13 NEW INTERIOR PARTITION, 2 x 6 WOOD STUDS, 16" g/c FILL WITH FIBERGLASS BATT INSULATION, 5/8" PAINTED DRYWALL
- 14 4" HIGH RUBBER DOVE BASE
- 15 RELOCATED FIRE ALARM PANEL (BY OWNER'S VENDOR)
- 16 5/8" PAINTED DRYWALL
- 17 5/4" x 8" 'HARDI-BOARD' SMOOTH TRIM OVER FLASHING
- 18 'HARDI-BOARD', SMOOTH LAP SIDING WITH 7" EXPOSURE OVER 'TYVEK' HOUSE WRAP
- 19 2 x 6 WOOD STUDS, 16" g/c WITH 2" CLOSED CELL SPRAY FOAM INSULATION (R=13.6) PLUS FIBERGLASS INSULATION IN REMAINDER OF CAVITY (R=13), TOTAL R=26.5.
- 20 5/4" x 6" 'HARDI-BOARD' SMOOTH TRIM

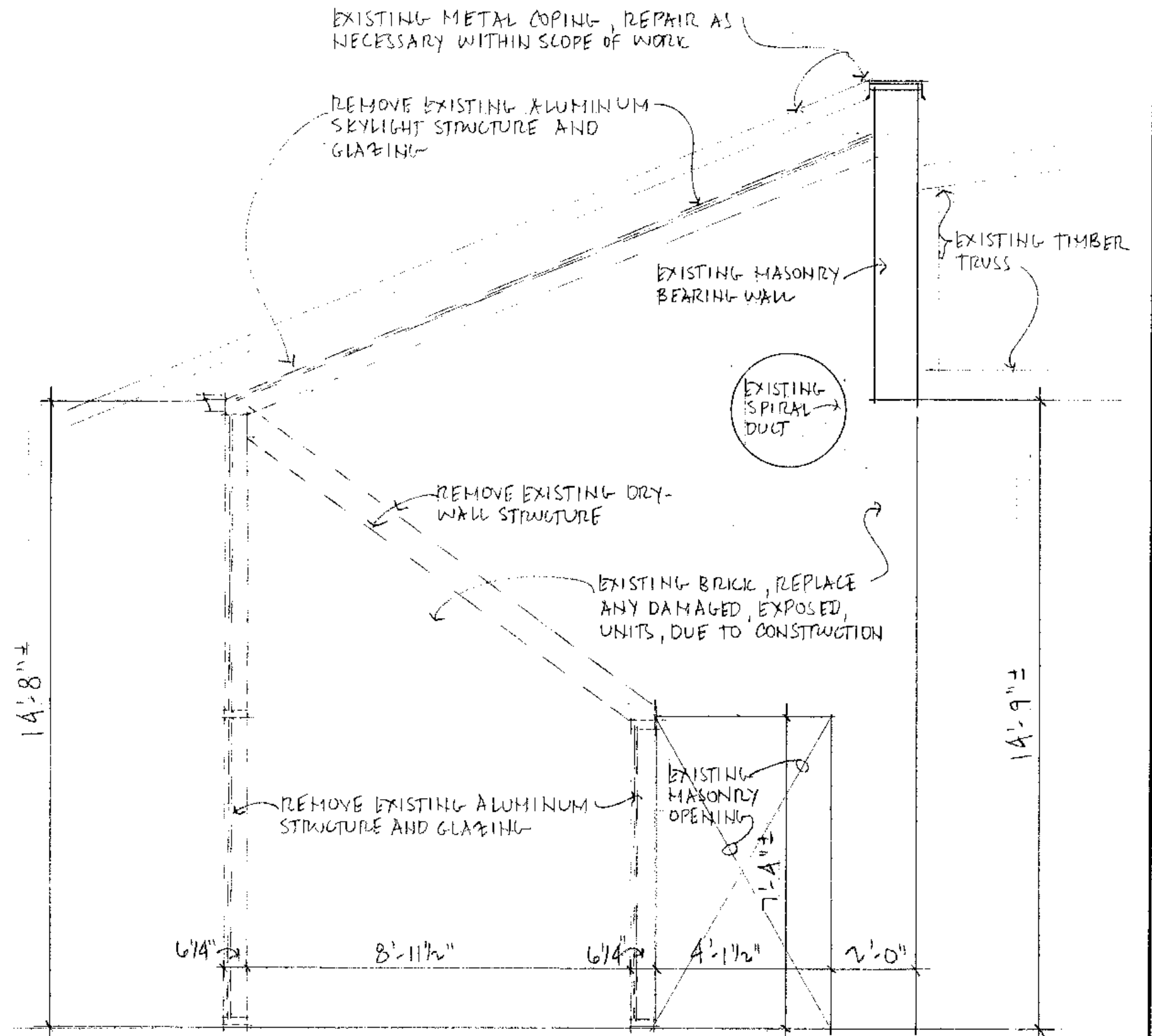

**Building Cross Section A - A**

SCALE: 3/8" = 1'-0"

- 21 'HARDI-BOARD', VENTED SOFFIT PANELS, SMOOTH
  - 22 WOOD BLOCKING, AS REQUIRED, 16" g/c
  - 23 STRIATED ALUMINUM 2 x 10 GUTTER BOARD
  - 24 6" 'K' STYLE, CONTINUOUS ALUMINUM GUTTER
  - 25 DRIP EDGE PER ROOFING MANUFACTURER'S RECOMMENDATIONS
  - 26 BAR STYLE, CONTINUOUS SHOW GUARD INSTALLED PER MANUFACTURER'S RECOMMENDATIONS
- \* ANY WOOD IN CONTACT WITH MASONRY OR CONCRETE SHALL BE TREATED
- \* CAULK ALL VERTICAL & HORIZONTAL CONNECTIONS,

7-29-16 ISSUED FOR PERMITS/BIDS

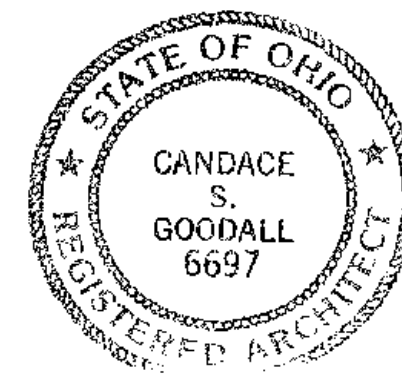

**CANDACE GOODALL**  
ARCHITECT

211 Finbury Lane  
Troy, Ohio 45373  
(937) 335-1579  
cg.arch@earthlink.net

SOUTH ENTRANCE RENOVATIONS		
Troy - Miami County Public Library		
SCALE:	APPROVED BY:	DRAWN BY: CANDY GOODALL
DATE: JULY 29, 2016		REVISED
419 WEST MAIN STREET		TROY, OHIO 45373
PROJECT # 2015-04		DRAWING NUMBER
		A-3 OF 8

\* CONTRACTORS SHALL VERIFY ALL EXISTING FIELD CONDITIONS AND DIMENSIONS!

# Door & Hardware Schedule

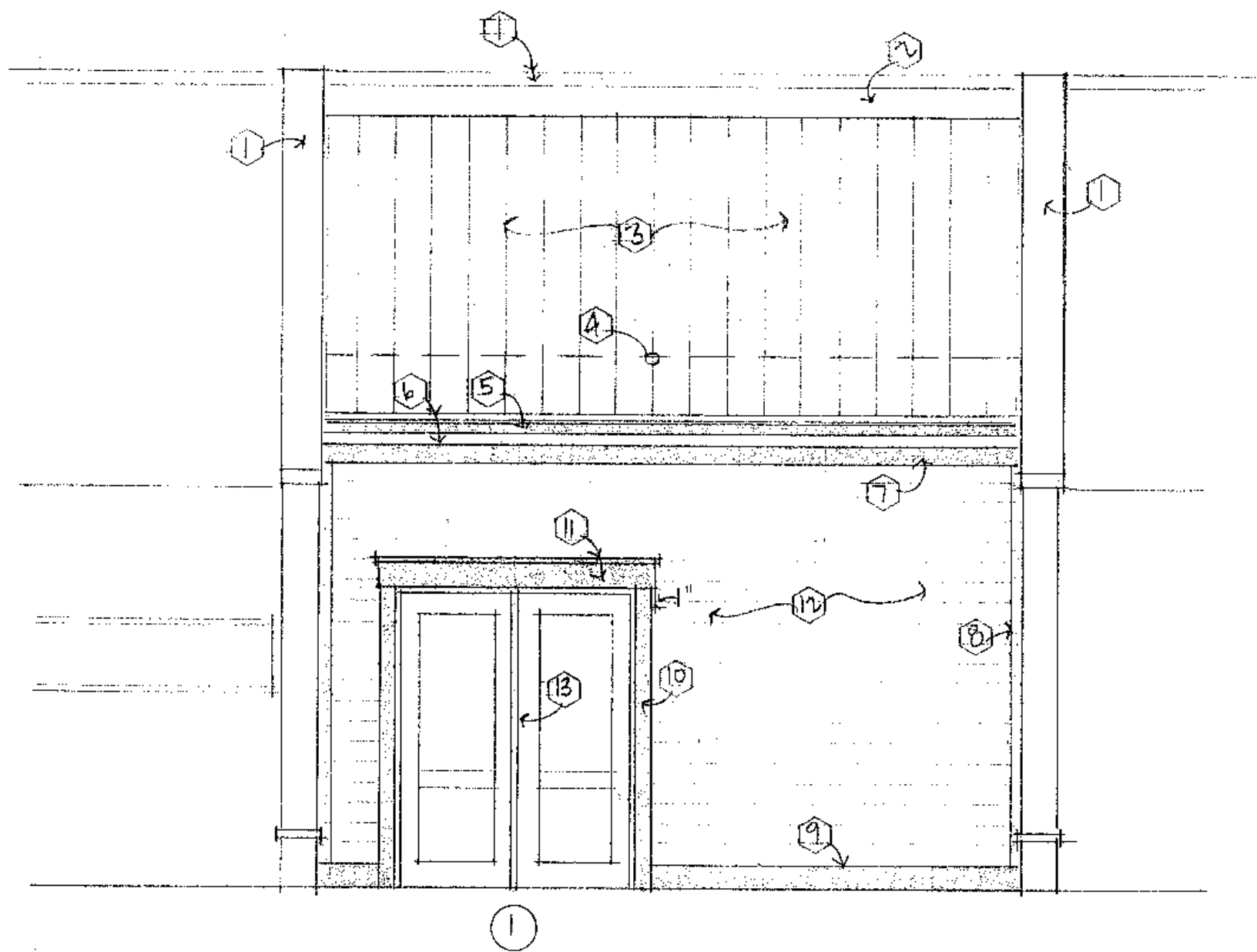

## South Side Renovated Exterior Entrance Elevation

SCALE: 1/4" = 1'-0"

- ① EXISTING METAL COPING, REPAIR AS NECESSARY WITHIN SCOPE OF WORK.
- ② FLASH HOW METAL ROOF INTO EXISTING COPING. INSTALL PER ROOFING MANUFACTURER'S RECOMMENDATIONS.
- ③ TYPICAL ROOF CONSTRUCTION  
 1/4 GAUGE, STANDING SEAM METAL ROOF SYSTEM, OVER 27# 'RAPTOR' SYNTHETIC UNDERLAYMENT OVER 5/8" EXTERIOR GRADE PLYWOOD SHEATHING OVER 2x10<sup>s</sup>, 16" OC.  
 METAL ROOF SYSTEM SHALL BE 'MPI' METAL PANEL SYSTEMS, INC., 1/4 GAUGE, G-90, GALVANIZED STEEL, MP-175, STANDING SEAM METAL ROOF SYSTEM. 12" WIDE, 13/4" HIGH, STRIATED ROOF PANELS, PVDF FLUOROPOLYMER COATING WITH 'KYNAR' 500 RESIN, 1.0 MIL, COLOR: 'DREXEL' 'AGED COPPER' # SR, 41. SUBMIT LARGER SAMPLE FOR FINAL APPROVAL PRIOR TO ORDERING, PROVIDE WITH A 20 YEAR FINISH WARRANTY, WRITTEN INSPECTION REPORT FROM MANUFACTURER AND A 20 YEAR WEATHERTIGHTNESS WARRANTY ON THE ROOF SYSTEM.  
 \* VERIFY SUBSTRATE IS UNIFORM, EVEN, AND SYMMETRICAL, SO WHEN PANELS ARE APPLIED THEY WILL NOT APPEAR WAVY OR DISTORTED.  
 \* ALL SEALANTS TO COMPLY WITH WATER TIGHTNESS WARRANTY.  
 \* ALL UNDERLAYMENT TO COMPLY WITH WATER TIGHTNESS WARRANTY.
- ④ INSTALL BAR STYLE SNOWGUARD, ENTIRE WIDTH OF ROOF, TO COMPLY WITH WATER TIGHTNESS WARRANTY, COLOR TO MATCH NEW ROOF
- ⑤ 6" 'K' STYLE ALUMINUM GUTTER, MATCH COLOR OF EXISTING DOWNSPOUT, TIE TO EXISTING DOWNSPOUT
- ⑥ STRIATED ALUMINUM, 2x10 GUTTER BOARD, MATCH COLOR OF NEW ROOF.
- ⑦ 5/4" x 6" SMOOTH 'HARDI-BOARD' TRIM, PAINTED 'SHERWIN-WILLIAMS' # SW 7032 - WARM STONE

mark	type	size	frame	glazing	fire rating	lintel	lockets		hardware							
							RIM PANIC	PRIVACY	CLOSER	BUTTS	WEATHERSTRIPPING	THRESHOLD	REMOVABLE ASTRAGAL	KICKPLATE	SIGN	
1	A	TWO, SEPARATE, 3'-0" x 8'-0", OUT-SWING	WOOD	1" TINTED, INSULATING		3'-2" x 10"	●		●	●	●	●	●			
2	A	TWO, SEPARATE, 3'-0" x 8'-0", OUT-SWING	WOOD	1" CLEAR INSULATING		3'-2" x 10"	●		●	●	●	●	●			
3	B	3'-0" x 7'-0" WOOD	HM			3'-2" x 10"	●		●	●			●			

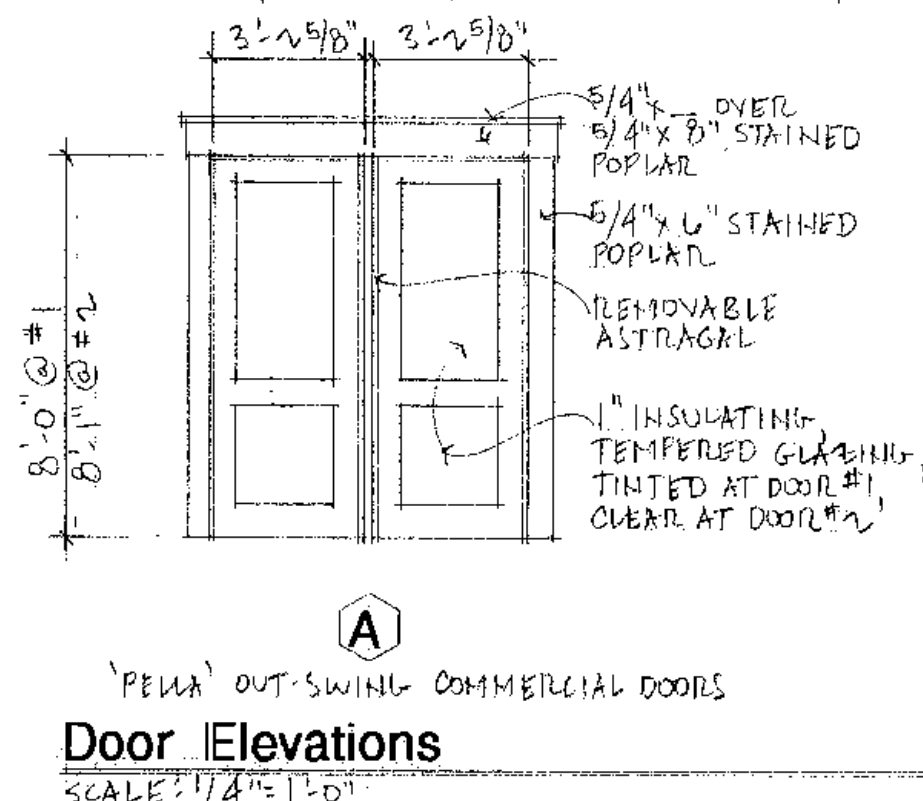

Door Elevations  
SCALE: 1/4" = 1'-0"

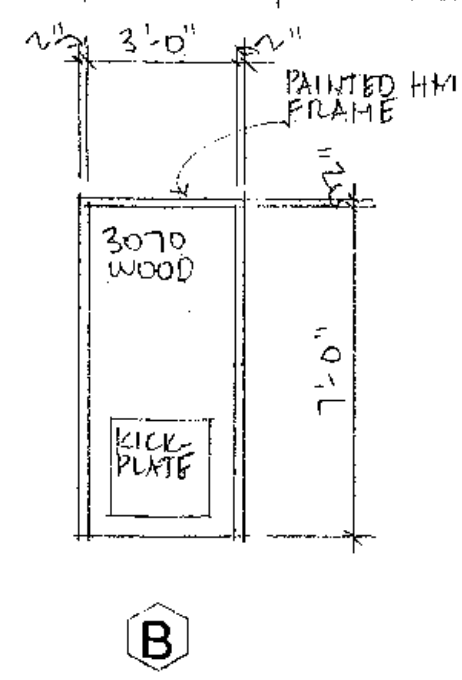

- ### Door & Hardware Notes
- HOLLOW METAL FRAMES SHALL BE 'AMWELD', OR EQUAL, 400 SERIES, 16 GAUGE. VERIFY THICKNESS REQUIRED. FRAMES SHALL BE WELDED, MITRED AND GROUND SMOOTH. TACK WELDING & FILLING WITH BODY PUTTY IS NOT PERMITTED.
  - ALL HARDWARE FINISHES SHALL MATCH EXISTING.
  - HARDWARE SHALL BE AS FOLLOWS:
    - \* LOCKSETS - 'HAGER' (VERIFY, MATCH EXISTING), GRADE ONE HEAVY DUTY, 3400 SERIES WITH 'AUGUST' LEVER HANDLE, MATCH EXISTING KEYING SYSTEM.
      - A RIM PANIC BAR  
'HAGER' # 4701 x 36 x 47 KE, KEY & LEVEL
      - B PRIVACY # 3440  
PUSH BUTTON LOCKING, TURNING INSIDE LEVER RELEASES PUSH BUTTON.
    - \* CLOSER - 'HAGER' # 5200 WITH HOLD OPEN
    - \* REMOVABLE MULLION - # 4900 UNKR, NON-KEYED
    - \* THRESHOLD - 'DURABLE PRODUCTS' # C205 WITH DOOR SWEEP # D480 CLA, VERIFY WIDTH
    - \* WEATHERSTRIPPING - 'NATIONAL GUARD' # 700 SA, SILICONE
    - \* BUTTS - 'HAGER' # BB1279, BALL BEARING
    - \* DOOR STOP - 'ROCKWOOD', OR EQUAL # 411 CONCAVE WROUGHT WALL STOP. APPLY ONE PER DOOR AS NEEDED, VERIFY CONDITION, WALL OR FLOOR.
    - \* KICKPLATE - 'ROCKWOOD' OR EQUAL, 24" HIGH x 32" WIDE, STANDARD DUTY, 0.50" STAINLESS STEEL
    - \* ALL OPENINGS WITH DOORS SHALL RECEIVE SILENCERS. INSTALL AFTER FRAMES ARE PAINTED.
    - \* WOOD DOORS - 1 3/4" SOLID CORE, PLAIN SLICED RED OAK WITH FINISHED EDGES, STAINED AND VARNISHED (MATCH EXISTING), 'CHAPPEL', OR EQUAL, PCS. VENEER SHALL BE UNIFORM IN GRAIN & COLORATION ONCE STAINED. ANY IRREGULARITIES IN DOOR FINISH/APPEARANCE, SHALL BE CAUSE FOR REJECTION.
    - \* SIGNS - PROVIDE ADA COMPLIANT SIGN AT TOILET ROOMS.
    - \* 'PELLA' OUT-SWING COMMERCIAL FRENCH DOOR UNIT
      - DOOR #1 - ALUMINUM CLAD EXTERIOR, 'BRICK RED', WOOD INTERIOR WITH 1" INSULATING, TINTED, TEMPERED GLAZING.
      - DOOR #2 - WOOD BOTH SIDES, 1" INSULATING, CLEAR, TEMPERED GLAZING.

- ⑧ HARDI-BOARD, SMOOTH CORNER TRIM 5/4" x 4", PAINTED, 'SHERWIN-WILLIAMS' # SW 7032 - WARM STONE.
- ⑨ 5/4" x 8" 'HARDI-BOARD' SMOOTH TRIM OVER FLASHING, PAINTED 'SHERWIN-WILLIAMS' # SW 7032 - WARM STONE
- ⑩ 5/4" x 6" 'HARDI-BOARD' SMOOTH TRIM, PAINTED, 'SHERWIN-WILLIAMS' # SW 7032 - WARM STONE.
- ⑪ FLASHING OVER 5/4" OVER 5/4" x 8" 'HARDI-BOARD' SMOOTH, BUILT-UP HEAD TRIM, PAINTED, 'SHERWIN-WILLIAMS' # SW 7032 - WARM STONE.
- ⑫ 'HARDI-BOARD' SMOOTH LAP SIDING WITH 7" EXPOSURE, PAINTED, 'SHERWIN-WILLIAMS' # SW 7030 - ANEW GRAY
- ⑬ REMOVABLE ASTRAGAL BETWEEN DOOR UNITS.
- \* PROVIDE CONCEALED FLASHING AT ALL HORIZONTAL AND VERTICAL CONNECTIONS.
- \* CAULK VERTICAL & HORIZONTAL JOINTS, ALL EXTERIOR CAULKING SHALL BE BY 'SIKA-CORP', 'SIKA-FLEX-1A', PREMIUM GRADE, HIGH PERFORMANCE, MOISTURE CURED, ONE COMPONENT, POLYURETHANE, NON-SAG, ELASTOMERIC SEALANT, INSTALLED PER MANUFACTURER'S RECOMMENDATIONS, VERIFY COLOR.

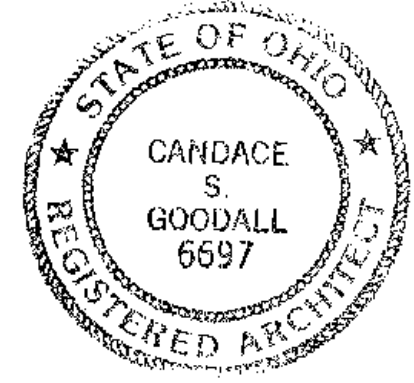

**CANDACE GOODALL**  
ARCHITECT  
211 Finbury Lane  
Troy, Ohio 45373  
(937) 335-1579  
cg.arch@earthlink.net

7-19-16 ISSUED FOR PERMITS/BIDS

SOUTH ENTRANCE RENOVATIONS		
Troy - Miami County Public Library		
SCALE:	APPROVED BY:	DRAWN BY: CANDY GOODALL
DATE: JULY 29, 2016		REVISED:
419 WEST MAIN STREET		TROY, OHIO 45373
PROJECT # 2015.04		DRAWING NUMBER A-4 of 8

\* CONTRACTOR'S SHALL VERIFY ALL EXISTING FIELD CONDITIONS AND DIMENSIONS!

**Room Finish Notes**

- \* ROOM #101 - ACCESSIBLE TOILET ROOM - CEILING - SUSPENDED ACOUSTICAL AT 8'-0" AFF FLOOR - 'KEY RESIN' WITH 6" HIGH INTEGRAL COVE BASE. WALLS - EPOXY PAINTED WATER RESISTANT DRYWALL
  - \* ROOM #102 - RENOVATED VESTIBULE - CEILING - BARN SIDING OVER 5/8" DRYWALL, 1x4 STAINED POPLAR TRIM AT PERIMETER FLOOR - CARPET SQUARES TO MATCH EXISTING / 4" HIGH RUBBER COVE BASE WALLS - PAINTED DRYWALL
  - \* ROOM #103 - DISPLAY LOFT - CEILING - BARN SIDING OVER 5/8" DRYWALL, 1x4 STAINED POPLAR TRIM AT PERIMETER FLOOR - CARPET SQUARES TO MATCH EXISTING READING AREAS WALLS - PAINTED DRYWALL / EXISTING EXPOSED BRICK
- \* REPAIR / PAINT ALL NEW DRYWALL / MATERIALS / CARPET, WITHIN SCOPE OF WORK AND AFFECTED BY CONSTRUCTION.

1. ALL NEW INTERIOR FINISHES SHALL COMPLY WITH CHAPTER 8 OF THE OBC.
2. INTERIOR DRYWALL SHALL BE 5/8" SCREWED IN PLACE, PROVIDE WATER RESISTANT DRYWALL IN NEW TOILET ROOM #101 & WALL AT COFFEE AREA. PROVIDE DRYWALL CONTROL JOINTS, AS REQUIRED, TO PREVENT CRACKING.
3. INSTALL 5/8" 'DUROCK' BEHIND 'KEY RESIN' INTEGRAL BASE IN TOILET ROOM.
4. SUSPENDED ACOUSTICAL CEILING SHALL BE 24" x 24" x 5/8" 'ARMSTRONG' #1831 'FINE FISSURED' SQUARE EDGE MINERAL FIBER CEILING TILES. PROVIDE WITH 'PRELUDE' 'ML' STANDARD, 15/16" WHITE, EXPOSED CEILING GRID. PROVIDE OWNER WITH ONE EXTRA CARTON OF CEILING TILE AT COMPLETION OF PROJECT.
5. CAULK ALL VERTICAL & HORIZONTAL JOINTS 'TREMCO' 'DYMERIC'.
6. SCHEDULE OF PAINTING:  
 'SHERWIN-WILLIAMS' SPECIFICATIONS SHALL BE USED TO ESTABLISH THE STANDARD OF QUALITY, INSTALL PER MANUFACTURER'S RECOMMENDATIONS.
  - \* METALS - PRIME, IF NOT PRIMED, WITH 'PRO-CRYLE' #B66W0310, TWO FINISH COATS 'PRO-INDUSTRIAL' #K46W0051, PRE-CATALYZED, WATER BASED, SEMI-GLOSS.
  - \* DRYWALL - INTERIOR LATEX PRIMER 'PRO-MAR 200' #B2B2W02600, TWO FINISH COATS #B24W00451 'PRO-MAR 200', INTERIOR LATEX, LOW SHEEN, (EPOXY TOP COAT #B73W00311 'PRO-INDUSTRIAL', WATER BASED EPOXY.
  - \* INTERIOR WOOD - ALKYD, SATIN FINISH 'SHERWOOD', BAC, WIPING STAIN, S64 SERIES, TWO COATS, 'WOOD CLASSIC', POLYURETHANE SATIN VARNISH.
7. RUBBER BASE: 'ROPPE', 4" HIGH RUBBER COVE
8. FLOOR COVERINGS:
  - \* PROVIDE SUITABLE SUB-BASE / FLOOR PREPARATION FOR TYPE OF FLOORING BEING INSTALLED
  - \* NEW CARPET SQUARES TO MATCH EXISTING
  - \* PROTECT ALL INSTALLED SURFACES, FROM CONSTRUCTION TRAFFIC. ANY DAMAGED SURFACES SHALL BE REPLACED BY THE GENERAL CONTRACTOR.

9. 'KEY RESIN COMPANY' - FLUID APPLIED FLOORING
  - \* FLOORING TO BE INSTALLED BY A CERTIFIED INSTALLER, INSTALL PER MANUFACTURER'S RECOMMENDATIONS. PROVIDE A 12" x 12" MOCK UP FOR APPROVAL PRIOR TO INSTALLATION.
  - SYSTEM SHALL BE 'KEY DIAMOND CHIP' WITH #467 URETHANE TOP COAT, 1/8" MOISTURE VAPOR TOLERANT EPOXY SURFACING WITH BROADCAST COLORED CHIPS (FLAKE) TO FORM A DECORATIVE SURFACE, SURFACE FINISH SHALL BE A TWO COMPONENT, UV LIGHT RESISTANT, EPOXY GROUT AND MOISTURE CURED URETHANE SEALER. VERIFY COLOR.
  - \* PROVIDE WITH 6" HIGH INTEGRAL COVE BASE, INSTALL OVER 5/8" 'DUROCK' WITH COVE CAP STRIP ABOVE & URETHANE SEALANT, 3/4" RADIUS AT COVE BASE.

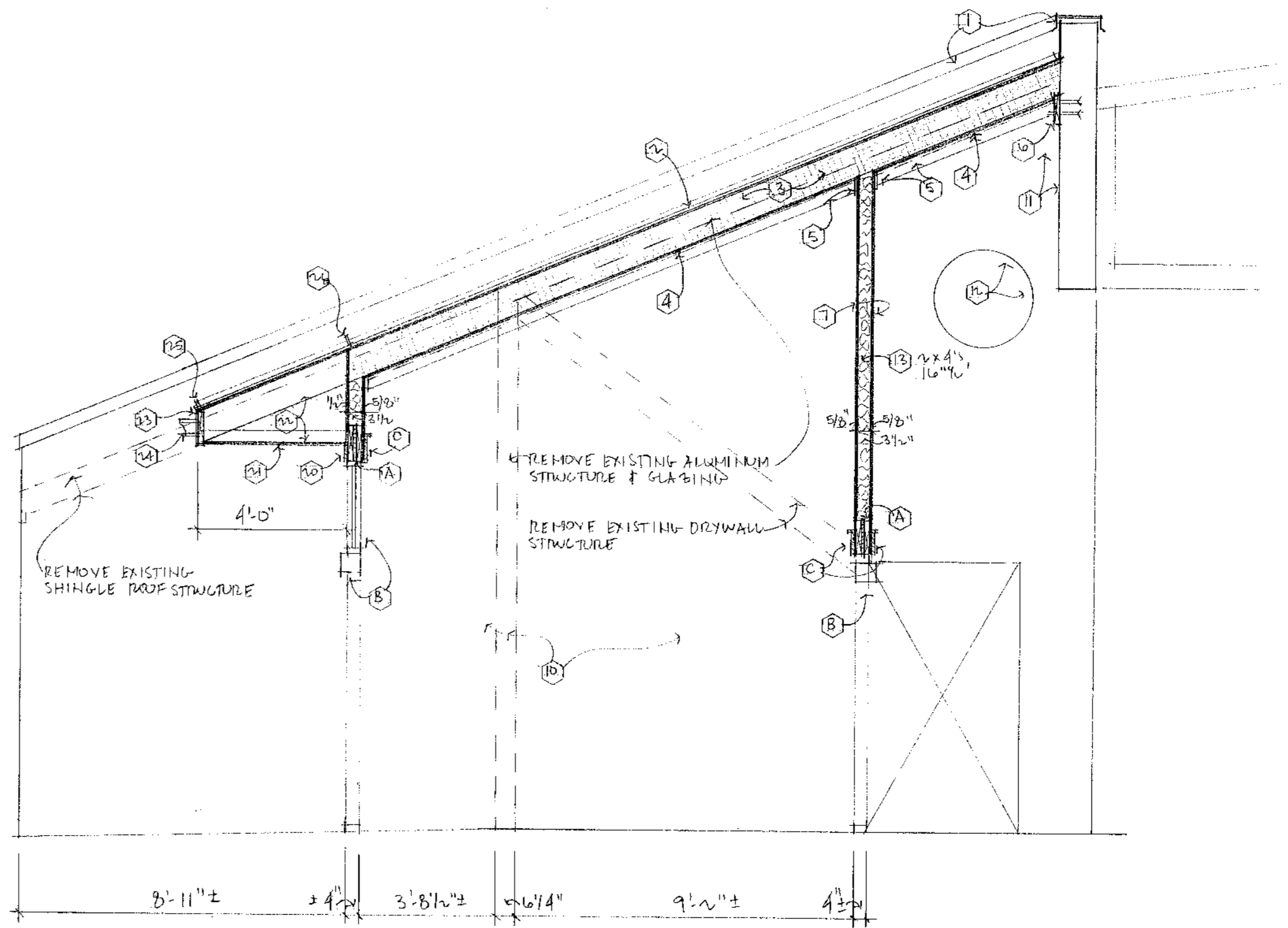

**Alternate Bid Item #1**  
**Section Through North Entrance**

SCALE: 3/8" = 1'-0"

- (X) - REFER TO NOTES ON SHEET # A-3
- (A) 2x4's WITH PLYWOOD BETWEEN, SECURE TO EXISTING MASONRY BEARING WALL WITH 'SIMPSON' MASONRY BEAM HANGER # MB10, EACH END.
- (B) AUTOMATIC SLIDING ALUMINUM DOORS & TRANSOM AT EXTERIOR UNIT TO BE PROVIDED AND INSTALLED BY OWNER'S VENDOR, G.C. TO COORDINATE
- (C) 5/4" x - OVER 5/4" x 8" STAINED, POPLAR TRIM BOARDS ACROSS TOP OF OPENINGS.

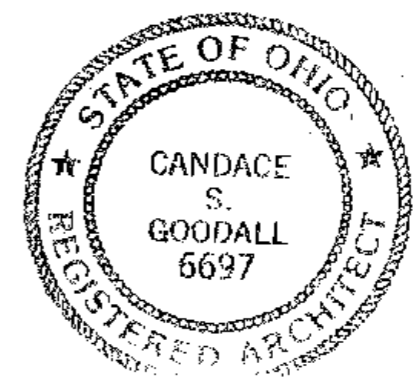

7-29-16 ISSUED FOR PERMITS / BIDS

**CANDACE GOODALL**  
 ARCHITECT

Commercial  
 Residential  
 Multi-Family

211 Finbury Lane  
 Troy, Ohio 45373  
 (937) 335-1579  
 cg.arch@earthlink.net

SOUTH ENTRANCE RENOVATIONS		
Troy - Miami County Public Library		
SCALE:	APPROVED BY:	DRAWN BY: <i>CANDACE GOODALL</i>
DATE: JULY 29, 2016		REVISED:
419 WEST MAIN STREET		TROY, OHIO 45373
PROJECT #2015-04		DRAWING NUMBER
		<b>A-5</b> of 8

\* CONTRACTOR'S SHALL VERIFY ALL EXISTING FIELD CONDITIONS AND DIMENSIONS!

**Plumbing Notes & Specs**

1. Plumbing Contractor shall determine the best method to facilitate installation of new plumbing work. Verify all conditions prior to starting work.
2. Saw cut, patch and repair any existing floor construction as required to facilitate the installation of new work.
3. All piping, including vents, shall be concealed. No exposed piping will be permitted.
4. Silicone seal fixtures to wall / floor.
5. All new underground piping shall be 4" minimum.
6. Install traps and stops to all plumbing fixtures.
7. All work shall be done in a workmanlike manner in accordance with all state and local codes.
8. Piping Schedule:
  - A. Sanitary (including vents) - Schedule 40, PVC
  - B. Hot and Cold Water - Type 'L' hard drawn copper. Insulate all piping with 1" thick elastomeric foam insulation.
9. All water, vent and other service piping shall run above the ceiling unless noted otherwise.
10. Drawing is schematic only. Plumbing Contractor to verify sizes and locations of all lines. Upon completion of all plumbing work, contractor shall furnish a copy of as-built drawings to the General Contractor.
11. Furnish and install chrome plated traps, drain piping, supply stops and risers on all plumbing fixtures subject to the general public's view.
12. Plumbing Contractor to provide schematics necessary for all State and local plumbing permits. P. C. shall obtain all necessary plumbing permits.
13. Provide all clean-outs, trap primers and vents required by code. All items to be concealed.
14. Bed all sewer piping in compacted granular material, at least 6" below bottom of pipe and up to a minimum of 4" above the pipe.

**Plumbing Fixture Schedule**

**P-1 Wall Hung-ADA Compliant Water Closet**

'Kohler' #K4325, or equal, white, vitreous china, wall mount, 15" high, 1.6 gpf, manual flush valve ('Sloan', 'Royal'), elongated bowl with heavy duty open front seat, 1,000# adjustable fixture support, J.R. Smith #210, or equal.

**P-2 Wall Hung China Lavatory**

'American Standard' #0356.041 with 'American Standard', 'Innsbrook Selectronic' centerset proximity faucet with #PWRX long life battery system. Provide with 'McGuire' offset lavatory drain #155WC, P-trap #8872-C, stop/supply kit #158 and pipe insulation.

**P-3 4" Interior Floor Drain**

'Wade', or equal, cast iron with membrane clamp and 'A' strainer.

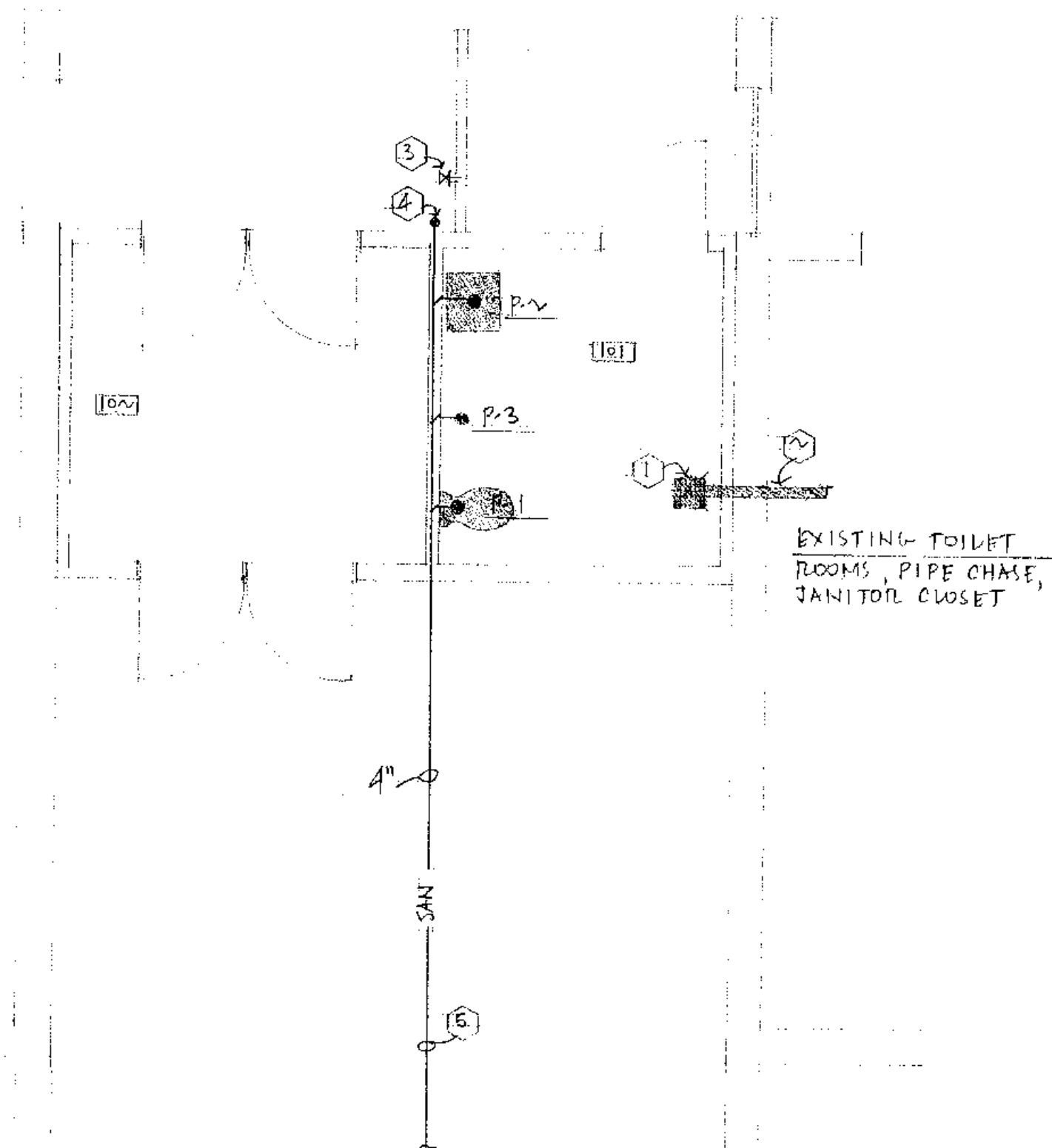

**Mechanical Plan**

SCALE: 1/4" = 1'-0"



\* COPY OF EXISTING PLUMBING/MECHANICAL DRAWINGS ATTACHED FOR REFERENCE, VERIFY ALL EXISTING CONDITIONS.

\* TIE NEW TOILET ROOM FIXTURES TO EXISTING DOMESTIC WATER SYSTEM. PROVIDE SHUT OFF VALVES TO ISOLATE NEW TOILET ROOM.

- 1 NEW 50 CFM EXHAUST, 14" X 12" STAINLESS STEEL EXHAUST GRILL MOUNTED IN NEW SUSPENDED ACOUSTICAL CEILING. GRILL TO BE CENTERED IN CEILING PAD.
- 2 NEW 4" Ø (OIL EQUIVALENT) ABOVE SUSPENDED CEILING. TIE TO EXISTING COMMON EXHAUST DUCT LOCATED IN PIPE CHASE BETWEEN EXISTING TOILET ROOM. EXISTING EXHAUST SYSTEM HAS ONE CENTRAL EXHAUST FAN.
- 3 PROVIDE WATER CONNECTION IN RECESSED VALVE BOX WITH COVER, FOR FUTURE COFFEE VENDING MACHINE.
- 4 CLEAN OUT
- 5 TIE NEW UNDERGROUND SANITARY PIPING TO EXISTING SANITARY LINE ON SOUTH SIDE OF BUILDING. SEE ATTACHED EXISTING PLUMBING DRAWINGS. SAW CUT EXISTING SLAB ALONG EXISTING CONCRETE JOINT LINES. G.C. TO REPLACE REMOVED CONCRETE WITH NEW TO MATCH EXISTING. DO NOT SAW CUT EXISTING STEPS. TURN NEW SANITARY PIPING TO GO BELOW LOW WALL AND INTO YARD SPACE, IF NEED BE.

17-09-16 ISSUED FOR PERMITS/BIDS

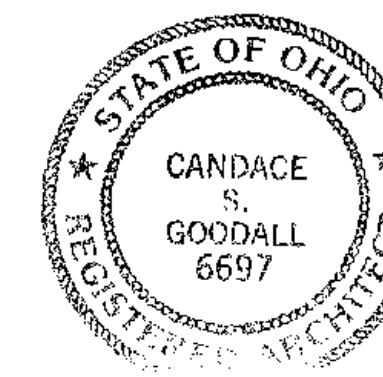

**CANDACE GOODALL**  
ARCHITECT  
211 Finbury Lane  
Troy, Ohio 45373  
(937) 335-1579  
cg.arch@earthlink.net

SOUTH ENTRANCE RENOVATIONS Troy - Miami County Public Library		
SCALE:	APPROVED BY:	DRAWN BY SANDY GOODALL
DATE: JULY 29, 2016		REVISED:
419 WEST MAIN STREET		TROY, OHIO 45373
PROJECT # 2015-04		DRAWING NUMBER <b>M-1</b> OF

\* CONTRACTOR'S SHALL VERIFY ALL EXISTING FIELD CONDITIONS AND DIMENSIONS!

NEW PANELBOARD 'P2A'													
MOUNTING SURFACE		VOLTAGE	PHASE	WIRE	GND	AMPS	MAIN	POLES	MINIMUM AIC RATING				
		208Y/120	3	4	YES	100	MCB	24	MAIN	BRANCH			
POLE	NO.	TRIP	P	LOAD SERVED		LOAD			LOAD SERVED	BREAKER	CKT	POLE	
					KVA	A	B	C	KVA	TRIP	P	NO.	NO.
1	1	20	1	HAND DRYER	1.5	2.5			1.0	20	1	2	2
3	3	20	1	LIGHTS & RECEPITS	1.5		2.3		0.8	20	1	4	4
5	5	20	1	SPARE	0.0			0.0	0.0	20	1	6	6
7	7	20	1	SPARE	0.0	0.0			0.0	20	1	8	8
9	9	20	1	SPARE	0.0		0.0		0.0	20	1	10	10
11	11	20	1	SPARE	0.0			0.0	0.0	20	1	12	12
13	13	20	1	SPARE	0.0	0.0			0.0	20	1	14	14
15	15	20	1	SPARE	0.0		0.0		0.0	20	1	16	16
17	17	20	1	SPARE	0.0			0.0	0.0	20	1	18	18
19	19	20	1	SPARE	0.0	0.0			0.0	20	1	20	20
21	21	20	1	SPARE	0.0		0.0		0.0	20	1	22	22
23	23	20	1	SPARE	0.0			0.0	0.0	20	1	24	24
TOTALS:					2.5	2.3	0.0		TOTAL:	4.8	KVA		

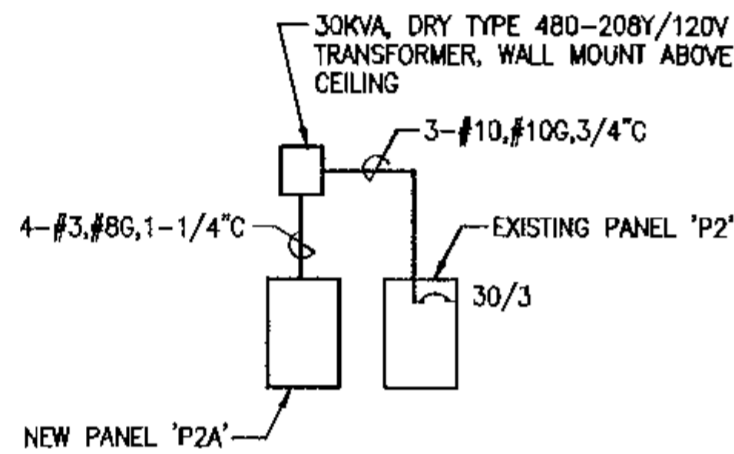

ELECTRICAL SERVICE LOAD	
LOAD REMOVED:	20.8KVA
LOAD ADDED:	4.8KVA
TOTAL:	-16.0KVA

### PARTIAL ELECTRICAL RISER DIAGRAM

SCALE: NONE

### ELECTRICAL SHEET NOTES

- EXISTING FIRE ALARM REMOTE ANNUNCIATOR TO BE RELOCATED TO NEW FURRED WALL BY OTHERS.
- EXTEND EXISTING LIGHTING OUTLET BOX TO NEW FURRED WALL AND PROVIDE BLANK STAINLESS STEEL COVERPLATE.
- REMOVE EXISTING UNIT HEATER AND WIRING BACK TO SOURCE. USE EXISTING 30A/3P CIRCUIT BREAKER IN PANEL 'P2' TO FEED NEW PANEL 'P2A'. REMOVE EXISTING RECEPTACLE AND DATA OUTLET AND WIRING BACK TO SOURCE.
- PROVIDE A RECESSED FAN FORCED WALL HEATER, 120V, 750 WATTS WITH INTEGRATED SWITCH AND REMOTE THERMOSTAT. HEATER SHALL BE EQUAL TO QMARK #CWH1151DSAF. MOUNT HEATER WITH TOP AT 42" A.F.F.. MOUNT REMOTE THERMOSTAT AT 48" A.F.F. WHERE INDICATED.
- PROVIDE A RECESSED FAN FORCED WALL HEATER, 120V, 1000 WATTS WITH INTEGRATED SWITCH AND REMOTE THERMOSTAT. HEATER SHALL BE EQUAL TO QMARK #CWH1101DSAF. MOUNT HEATER WITH TOP AT 42" A.F.F.. MOUNT REMOTE THERMOSTAT AT 48" A.F.F. WHERE INDICATED.
- PROVIDE OUTLET AND CONNECTION FOR HAND DRYER.
- REMOVE EXISTING LIGHT FIXTURE AND WIRING BACK TO SOURCE.
- CONNECT TO UNSWITCHED CIRCUIT TO LIGHTING ABOVE.
- EXTEND EXISTING EMERGENCY LIGHTING FIXTURE OUT TO FURRED WALL IN VESTIBULE.
- PROVIDE A 0-10V DIMMER EQUAL TO LEVITON #IP710-DL. LOCATE ON WEST SIDE OF VESTIBULE DOOR.
- REMOVE EXISTING LIGHT FIXTURE, PROVIDE COVERPLATE AND EXTEND 1/2" EMT CONDUIT UP WALL TO NEW CEILING AND CONNECT NEW TYPE 'C' FIXTURE TO EXISTING LIGHTING CIRCUIT. THIS WORK INCLUDED IN ALTERNATE BID ITEM 1 ONLY.

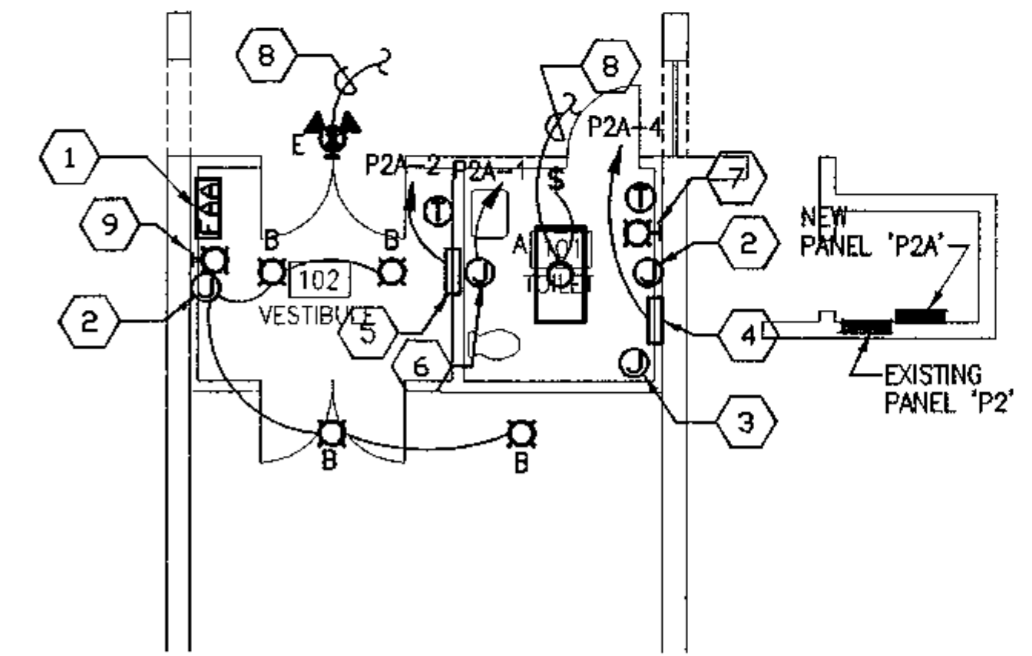

### SOUTH ENTRANCE FLOOR PLAN

SCALE: 1/8"=1'-0"

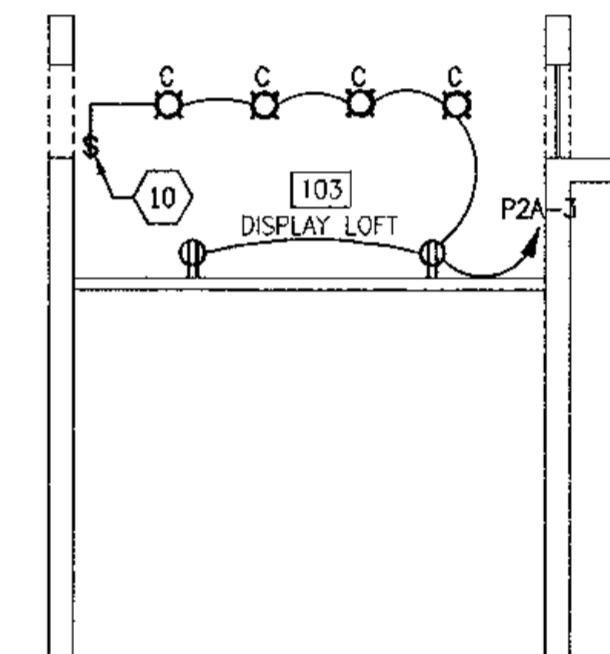

### SOUTH ENTRANCE DISPLAY LOFT

SCALE: 1/8"=1'-0"

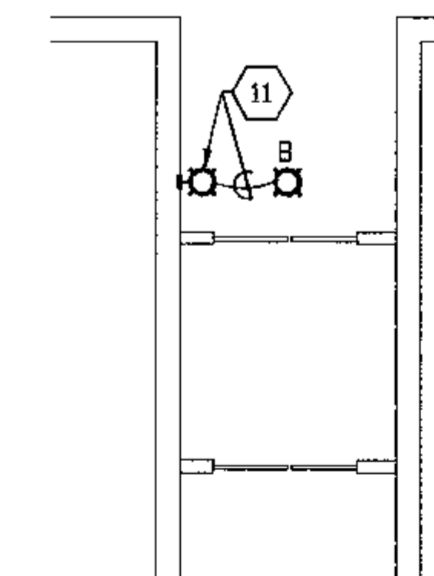

### NORTH ENTRANCE FLOOR PLAN

SCALE: 1/8"=1'-0"

LIGHTING LEGEND	
GENERAL: LETTER ADJACENT TO FIXTURE REFERS TO FIXTURE SCHEDULE.	
○	LAY-IN CEILING MOUNTED FLUORESCENT OR LED LIGHTING FIXTURE.
◻	RECESSED FLUORESCENT OR LED OR HID LIGHTING FIXTURE.
◻	WALL MOUNTED FLUORESCENT, LED OR HID LIGHTING FIXTURE
⊙	WALL MOUNTED EXIT SIGN WITH 90 MINUTE BACKUP BATTERY
WIRING LEGEND	
—	CONDUIT CONCEALED IN WALLS OR CEILING.
#10, #10G	NEUTRAL, PHASE AND GROUND WIRES. RESPECTIVELY, SIZE PER NEC.
—	HOMERUN TO PANEL BOARD (PANEL A, CIRCUIT 12 INDICATED).
⊕	JUNCTION BOX, WALL MOUNTED FLUSH, 4"X4" UNLESS NOTED OTHERWISE.
EQUIPMENT LEGEND	
\$	SINGLE POLE SWITCH, 3=3 WAY, 4=4 WAY, M=MANUAL STARTER, P=PILOT
⊕	NEMA 5-15R OR 5-20R DUPLEX RECEPTACLE GFI=GROUND FAULT INTERRUPTER
⊕	SPECIAL RECEPTACLE, SEE NOTES
⊕	MOTOR CONNECTION

LIGHT FIXTURE SCHEDULE			
A	2 X 4 LAY-IN LED GRID TROFFER - 3-3/4" MINIMUM DEPTH BODY - COLD ROLLED STEEL HOUSING, ALUMINUM DOOR - 120V HIGH EFFICIENCY LED DRIVER - 4300 LUMENS, 3000K, 82 CRI LITHONIA #2TL4 48L FW MWS D50 LPB30 NX METALUX EQUAL DAYBRITE EQUAL	E	LED BATTERY POWERED EXIT SIGN WITH DUAL HEADS - POLYCARBONATE HOUSING - 25 YEAR LONG LIFE LED LAMPS - CHEVRON DIRECTIONAL INDICATOR - MAINTENANCE FREE NI-CAD BATTERY - UNIVERSAL MOUNTING CAPABILITY - TWO LED LAMPS - 120/277 DUAL INPUT VOLTAGE LITHONIA #LHQM LED R SURE-LITES EQUAL EMERGI-LITES EQUAL
B	RECESSED LED DOWNLIGHT - 6-1/2" DEPTH DIE-CAST HOUSING - CLEAR DIFFUSE OPEN - DAMP LOCATION LISTING - 277 VOLT HIGH EFFICIENCY LED DRIVER - 3500K COLOR TEMPERATURE, 1000 LUMENS LITHONIA #LDN6 35/10 LOGAR 277 PORTFOLIO EQUAL KIRLIN EQUAL	D	EXTERIOR LED WALL MOUNT - DIE-CAST ALUMINUM HOUSING - THERMALLY ISOLATED LED DRIVER - ACRYLIC LENS - LISTED WET LOCATION - 3000K COLOR TEMPERATURE, 1000 MA DRIVE - BRONZE FINISH - CONNECT TO EXISTING CONTROLLED CIRCUIT LITHONIA #DSXW1 LED 20C 1000 30K T2M 277 FAIL-SAFE EQUAL HUBBELL EQUAL
C	RECESSED LED ADJUSTABLE DOWNLIGHT - 7-1/2" DEPTH DIE-CAST HOUSING, L5 LED24 - WHITE FINISH - DAMP LOCATION LISTING - 120 VOLT HIGH EFFICIENCY LED DRIVER - 3000K COLOR TEMPERATURE, 83 CRI LITHONIA #5GI MW LED L5 LED 24 PORTFOLIO EQUAL KIRLIN EQUAL	P	EXTERIOR LED POLE MOUNT - DIE-CAST ALUMINUM HOUSING - THERMALLY ISOLATED LED DRIVER - ACRYLIC LENS - LISTED WET LOCATION - 3000K COLOR TEMPERATURE, 1000 MA DRIVE - BRONZE FINISH - MOUNT TO EXISTING POLE - PROVIDE WITH TENON SLIPFITTER, VERIFY SIZE - CONNECT TO EXISTING CONTROLLED CIRCUIT LITHONIA #DSX0 LED 40C 1000 30K T3M 277 FAIL-SAFE EQUAL HUBBELL EQUAL

**Wehrkamp Engineering Inc**  
Consulting Engineers  
1805 Laurel Creek Drive Troy, OH 45378  
937 216 8147 mwehrkamp@wehrkampengr.com



SOUTH ENTRANCE RENOVATIONS  
**TROY - MIAMI COUNTY PUBLIC LIBRARY**  
419 WEST MAIN STREET TROY, OH 45373

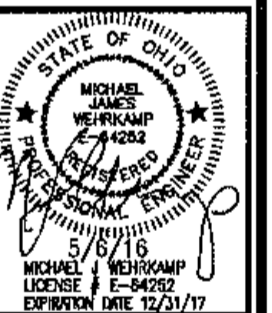

REVISIONS	
COMM. NO.	1617
DRAWN BY	MJW
DATE	28 JULY 2016
SHEET NO.	<b>E1</b>
ELECTRICAL PLANS AND DETAILS	

## ELECTRICAL GENERAL NOTES

ALL ELECTRICAL WORK SHALL COMPLY WITH ALL RECOMMENDED AND MANDATORY RULES AND REGULATIONS OF THE LATEST EDITION OF THE NATIONAL ELECTRICAL CODE, OHIO BUILDING CODE, AND ANY OTHER STATE OR LOCAL CODES. WHERE THE CONTRACT DOCUMENTS CALL FOR MATERIALS OR INSTALLATIONS MORE STRINGENT THAN PREVAILING CODES, THE CONTRACT DOCUMENTS SHALL GOVERN.

THE CONTRACTOR SHALL OBTAIN ALL PERMITS NECESSARY. THE CONTRACTOR SHALL FURNISH ELECTRICAL INSPECTION BY AN AGENCY LICENSED OR OTHERWISE QUALIFIED TO PERFORM ELECTRICAL INSPECTIONS IN THE STATE OF OHIO. ALL COSTS INCIDENTAL TO THE ELECTRICAL INSPECTION SHALL BE BORNE BY THE CONTRACTOR. THE CONTRACTOR SHALL FURNISH CERTIFICATES OF APPROVAL BY THE ELECTRICAL INSPECTOR. FINAL PAYMENT WILL BE WITHHELD UNTIL A FINAL CERTIFICATE OF APPROVAL HAS BEEN DELIVERED TO THE OWNER. FURNISH A COPY OF THE CERTIFICATE TO THE ARCHITECT.

THE CONTRACTOR SHALL COORDINATE THE LOCATION OF ALL EQUIPMENT AND CONDUIT ROUTING WITH ALL OTHER TRADES AND SHIFT LOCATIONS WHERE NECESSARY.

REFER TO THE ARCHITECTURAL DRAWINGS FOR LOCATIONS OF LIGHT FIXTURES AND OTHER DEVICES. COORDINATE WITH ARCHITECTURAL DRAWINGS FOR DEVICES LOCATED IN/AT CASEWORK.

THE ELECTRICAL CONTRACTOR SHALL FURNISH FRACTIONAL HP MANUAL STARTERS FOR ALL MANUALLY OPERATED SINGLE PHASE, ONE SPEED MOTORS UNLESS OTHERWISE INDICATED ON THE DRAWINGS. ALL OTHER STARTERS FOR MECHANICAL AND PLUMBING EQUIPMENT SHALL BE PROVIDED BY THE ASSOCIATED TRADE CONTRACTOR.

UNLESS OTHERWISE INDICATED ON THE DRAWINGS, ALL REQUIRED AND/OR INTERLOCK AND CONTROL WIRING INVOLVING MECHANICAL AND PLUMBING EQUIPMENT AND SYSTEMS SHALL BE PROVIDED BY THE ASSOCIATED TRADE CONTRACTOR.

IN ALL CASES WHERE CONDUITS, ETC, PASS THROUGH FIRE WALLS AND PARTITIONS, THE SPACES BETWEEN THE STRUCTURE OR SLEEVE AND THE PENETRATING MEMBER SHALL BE PROVIDED WITH A FIRESTOP SEALANT TO PRODUCE A FIRE, SMOKE AND WATER BARRIER. SEALANT MATERIAL SHALL BE NONCOMBUSTIBLE AS DEFINED BY ASTM E-136.

EMT (ELECTRICAL METALLIC TUBING) SHALL BE USED INSIDE THE BUILDING AND IT SHALL BE ZINC COATED ON THE INSIDE AND OUTSIDE. FITTINGS MAY BE COMPRESSION TYPE OR SET SCREW TYPE. MINIMUM SIZE SHALL BE 1/2" DIAMETER. RGS (RIGID GALVANIZED STEEL) SHALL BE USED OUTSIDE THE BUILDING AND SHALL BE GALVANIZED ON THE OUTSIDE AND ZINC COATED ON INSIDE. FITTINGS SHALL BE SUBJECT TO THE SAME REQUIREMENTS AS THE CONDUIT AND UL APPROVED. PVC (POLYVINYLCHLORIDE) SHALL BE USED UNDERGROUND/RISER OUTSIDE THE BUILDING.

ALL CONDUCTORS SHALL BE 98% CONDUCTIVITY COPPER, STRANDED, THHW OR THHN INSULATED AND RATED AT 600 VOLTS. UNLESS OTHERWISE INDICATED, NO CONDUCTORS SHALL BE SMALLER THAN AWG #12. ALL 120 VOLT CIRCUITS IN EXCESS OF 200' SHALL USE #10 AWG. NON-METALLIC SHEATHED CABLE (ROMEX) WILL BE PERMITTED IN ACCORDANCE WITH NEC. ALUMINUM CONDUCTORS MAY BE USED FOR SERVICE ENTRANCE CONDUCTORS WITH PROPER TERMINATIONS.

CIRCUITS INDICATED MAY BE COMBINED IN A SINGLE CONDUIT PROVIDED DERATING AND CONDUIT FILL REQUIREMENTS ARE MET. SHARED NEUTRALS ARE NOT PERMITTED.

A SEPARATE GROUNDING CONDUCTOR SHALL BE INSTALLED IN EACH CONDUIT. GROUNDING SHALL BE IN ACCORDANCE WITH ARTICLE 250 OF THE NATIONAL ELECTRICAL CODE.

ALL BOXES SHALL BE STEEL OF THE SAME GAGE AS THAT USED IN THE INDUSTRY FOR PANELBOARDS. PLASTIC BOXES WILL NOT BE ACCEPTABLE.

UNLESS OTHERWISE SPECIFICALLY SHOWN, ALL JUNCTION BOXES AND CONDUIT SHALL BE INSTALLED IN CONCEALED SPACES, EXCEPT FOR MECHANICAL ROOM, PIPE CHASE AND FIELD EQUIPMENT, WHERE THEY MAY RUN EXPOSED. ROUTE THROUGH WALLS AND FLOORS WHERE NECESSARY.

WIRING DEVICES SHALL BE SPECIFICATION GRADE, 15 OR 20 AMP, 120 VOLT. FACE PLATES SHALL MATCH DEVICE, COORDINATE COLORS WITH ARCHITECT.

PANELBOARD DIRECTORIES SHALL BE TYPEWRITTEN AND FULLY FILLED OUT AT THE TIME OF THE FINAL INSPECTION INDICATING THE LOCATION AND TYPE OF LOAD BEING SERVED.

LIGHT SWITCHES SHALL BE MOUNTED WITH CENTERLINE AT 42", RECEPTACLES AND DATA OUTLETS AT 18", UNLESS NOTED OTHERWISE. ALL DEVICES AND EQUIPMENT SHALL BE MOUNTED PER NEC, NFPA, AND ADAAG REQUIREMENTS. FIELD VERIFY ALL MOUNTING HEIGHTS OF DEVICES WITH OWNER PRIOR TO ROUGH-IN.

COORDINATE ALL RECESSED CAN LIGHTS WITH CEILING JOISTS. PROVIDE LAYOUT TO ARCHITECT/ENGINEER FOR APPROVAL PRIOR TO INSTALLATION.

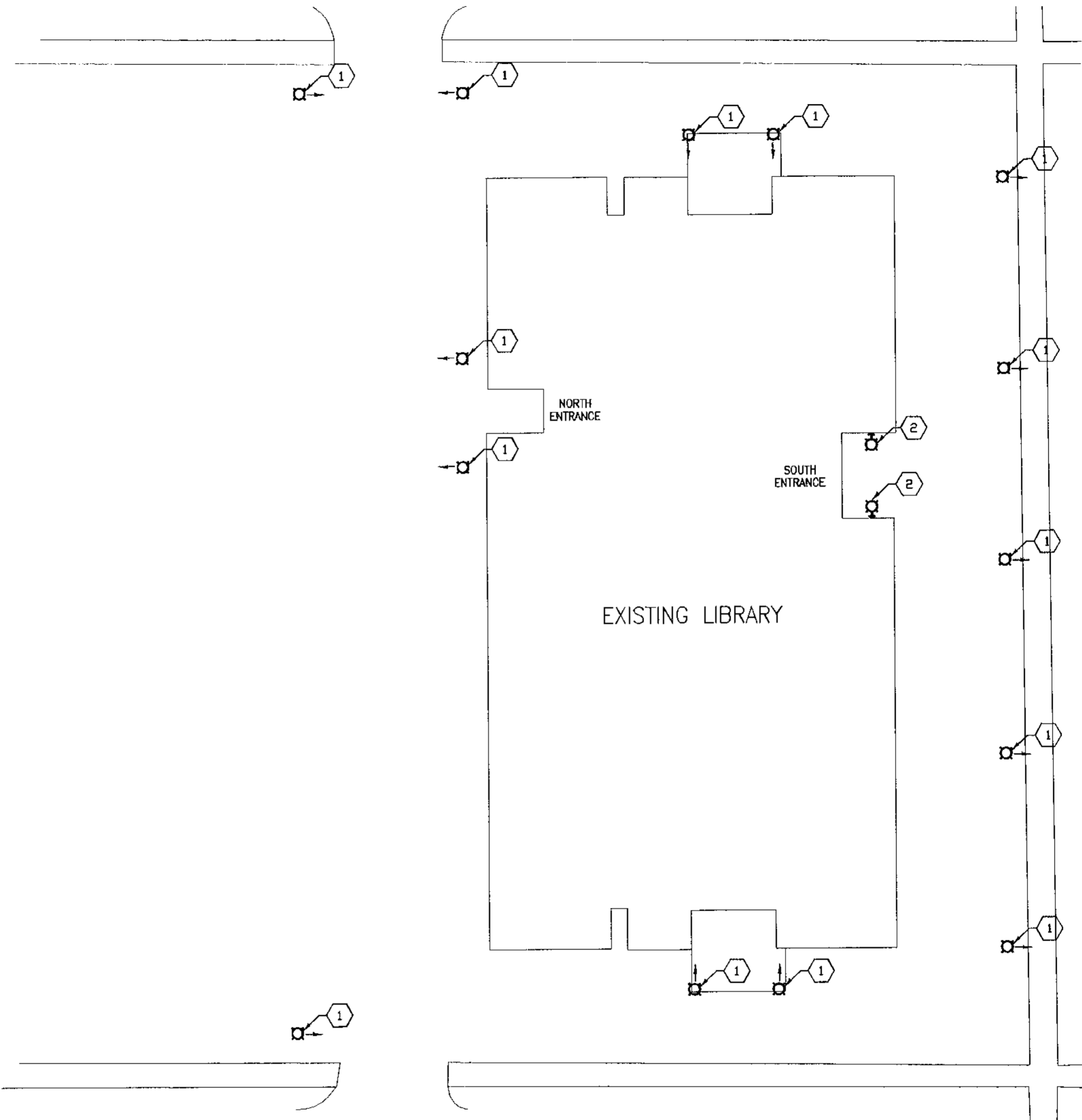

## ELECTRICAL SHEET NOTES

- ① REPLACE EXISTING LIGHT FIXTURE WITH NEW TYPE 'P' FIXTURE. PROVIDE A NEW BRONZE FINISH POLE TOP TENON FOR MOUNTING ON EXISTING POLE. MOUNT FIXTURE IN DIRECTION OF INDICATED ARROW. THIS WORK IS INCLUDED IN ALTERNATE BID ITEM E-1 ONLY.
- ② REPLACE EXISTING WALL MOUNT FIXTURE WITH TYPE 'D' FIXTURE. THIS WORK IS INCLUDED IN ALTERNATE BID ITEM E-1 ONLY.

## ALTERNATE BID ITEM E-1 ELECTRICAL SITE PLAN

SCALE: 1"=20'-0"



**Wehrkamp Engineering Inc**  
Consulting Engineers  
1805 Laurel Creek Drive Troy, OH 45373  
937 216 8147 mwehrkamp@wehrkampengr.com



SOUTH ENTRANCE RENOVATIONS  
**TROY - MIAMI COUNTY PUBLIC LIBRARY**  
419 WEST MAIN STREET TROY, OH 45373

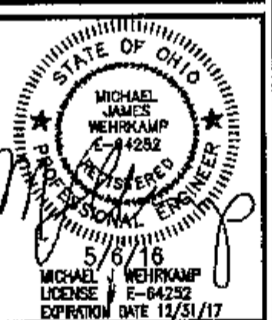

### REVISIONS

NO.	DATE	DESCRIPTION

COMM. NO.  
1617  
DRAWN BY  
M/W  
DATE  
28 JULY 2016  
SHEET NO.

**E2**  
of 5

ELECTRICAL SITE PLAN



**NOTE - ALT P-6**  
 ALL EXTERIOR STORM WORK (WITH THE EXCEPTION OF THE PARKING AREA CATCH BASIN & RELATED LATERALS) SHALL BE INCLUDED UNDER ALT P-6.  
 -REFER TO FLOOR PLANS FOR ADDITIONAL STORM WORK TO BE INCLUDED UNDER ALT P-6.

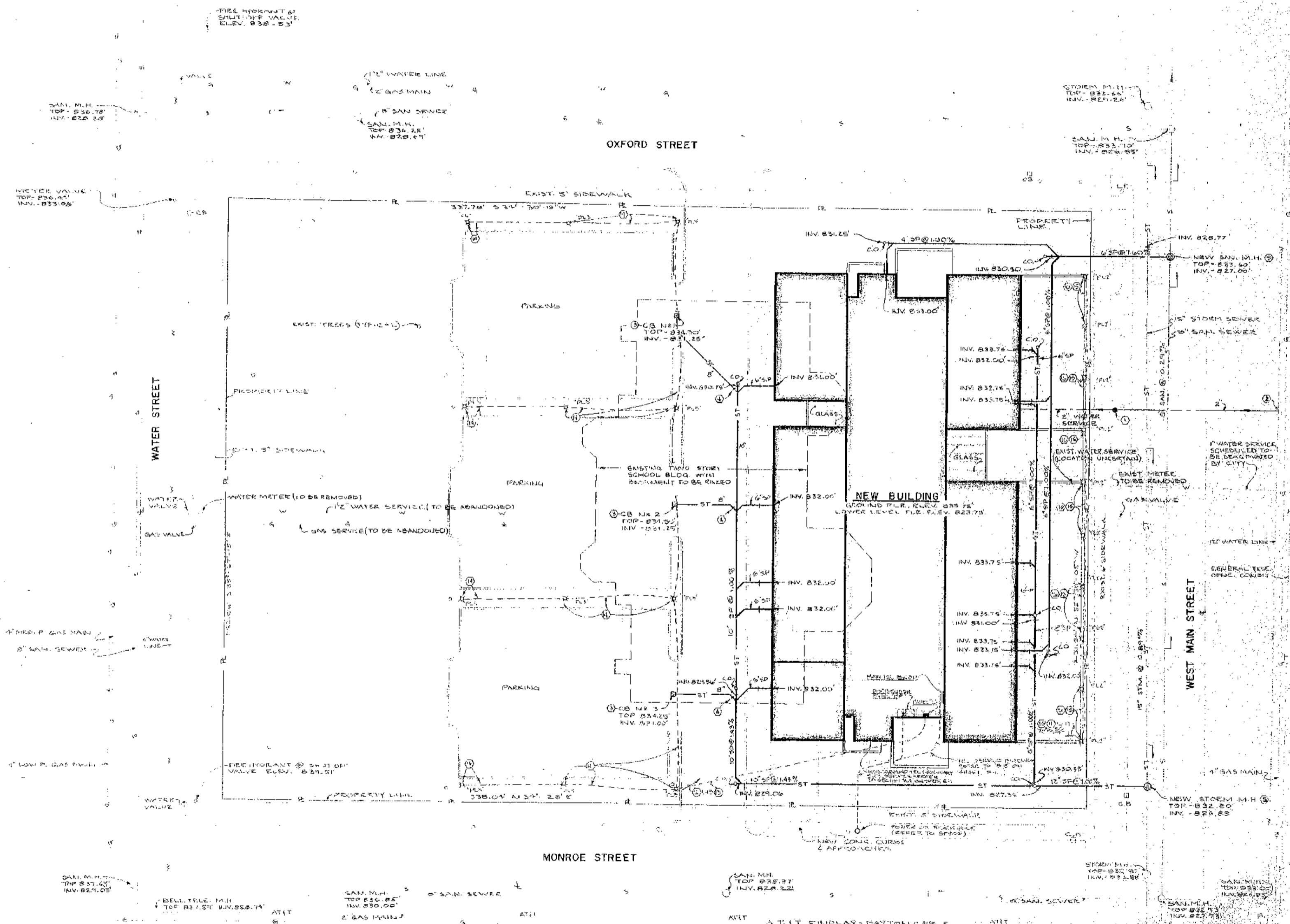

- LEGEND**
- SANITARY SEWER
  - WATER
  - GAS
  - STORM
  - VALVE
  - CHECK VALVE
  - MANHOLE
  - DIRECTION OF FLOW
  - DIRECTION OF DOWNWARD PITCH
  - FIXTURE SYMBOL
  - DRAIN SYMBOL
  - SOIL STACK / WASTE STACK
  - VENT STACK
  - DOWNSEWER
  - CLEANOUT
  - CAST IRON PIPE
  - EXTERIOR SEWER PIPE
  - MANHOLE
  - CATCH BASIN
  - FIRE EXTINGUISHER AND CABINET
  - FIRE EXTINGUISHER AND WALL BRACKET
  - PLUMBING CONTRACTOR
  - MECHANICAL CONTRACTOR
  - ELECTRICAL CONTRACTOR
  - GENERAL CONTRACTOR
- NOTE: SYMBOL NUMBER APPLIES ONLY TO SHEET NO. 10 WHICH SYMBOL IS SHOWN.  
 UP TO SYMBOL INDICATES HATCHURE DRAIN OR SEWER LINE TO BE REMOVED OR FLOORED ABOVE.

- PLUMBING NOTES**
1. ALL WORK SHALL BE IN ACCORDANCE WITH THE CITY OF TROY STANDARDS AND SPECIFICATIONS FOR PLUMBING AND MECHANICAL WORK.
  2. ALL WORK SHALL BE IN ACCORDANCE WITH THE CITY OF TROY STANDARDS AND SPECIFICATIONS FOR PLUMBING AND MECHANICAL WORK.
  3. ALL WORK SHALL BE IN ACCORDANCE WITH THE CITY OF TROY STANDARDS AND SPECIFICATIONS FOR PLUMBING AND MECHANICAL WORK.
  4. ALL WORK SHALL BE IN ACCORDANCE WITH THE CITY OF TROY STANDARDS AND SPECIFICATIONS FOR PLUMBING AND MECHANICAL WORK.
  5. ALL WORK SHALL BE IN ACCORDANCE WITH THE CITY OF TROY STANDARDS AND SPECIFICATIONS FOR PLUMBING AND MECHANICAL WORK.

- ELECTRICAL NOTES**
1. ALL WORK SHALL BE IN ACCORDANCE WITH THE CITY OF TROY STANDARDS AND SPECIFICATIONS FOR ELECTRICAL WORK.
  2. ALL WORK SHALL BE IN ACCORDANCE WITH THE CITY OF TROY STANDARDS AND SPECIFICATIONS FOR ELECTRICAL WORK.
  3. ALL WORK SHALL BE IN ACCORDANCE WITH THE CITY OF TROY STANDARDS AND SPECIFICATIONS FOR ELECTRICAL WORK.
  4. ALL WORK SHALL BE IN ACCORDANCE WITH THE CITY OF TROY STANDARDS AND SPECIFICATIONS FOR ELECTRICAL WORK.
  5. ALL WORK SHALL BE IN ACCORDANCE WITH THE CITY OF TROY STANDARDS AND SPECIFICATIONS FOR ELECTRICAL WORK.

PROJECT NO.	7244
DRAWN	
CHECKED	
APPROVED	
PREPARED	
DATE	

**RICHARD LEVIN ASSOCIATES, INC. ARCHITECTS**  
 24 NORTH JEFFERSON STREET - DAYTON, OHIO 45402 - 513-228-1791

**TROY MIAMI COUNTY PUBLIC LIBRARY**



PLOT PLAN  
 SCALE: 1" = 20'-0"

**SHEET ATTACHED FOR REFERENCE ONLY**

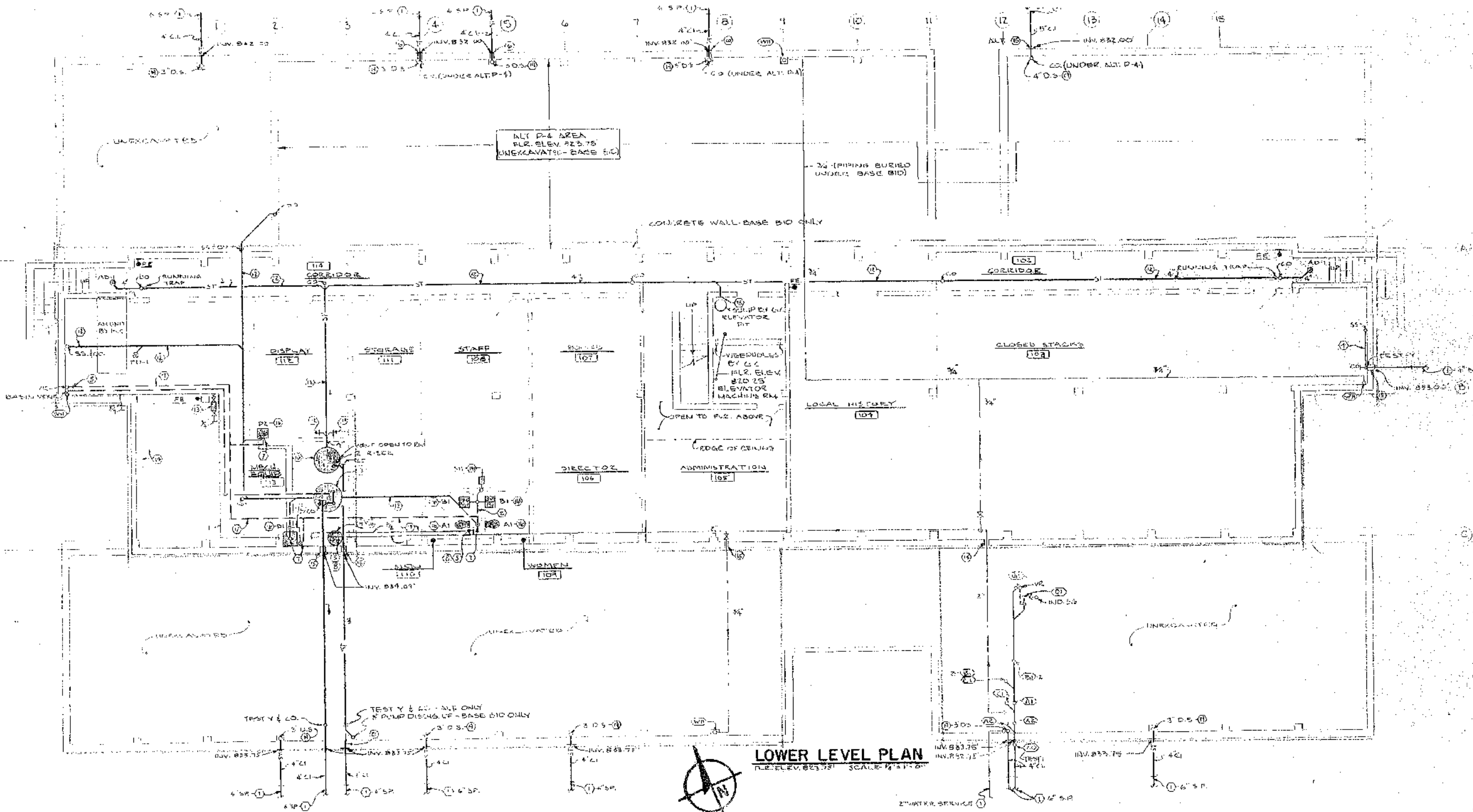

**GENERAL NOTES**

- 1) ALL SANITARY PIPING IS BELOW GRADE LEVEL UNLESS OTHERWISE INDICATED.
- 2) ALL SUPPLY PIPING VENT PIPING IS ABOVE THE CEILING UNLESS OTHERWISE INDICATED.
- 3) REFER TO SCHEDULES & PIPING DIAGRAMS FOR ALL PIPING AND FITS. SEE ALSO ELEVATIONS ON THE FLOOR PLAN.
- 4) REFER TO ARCHITECTURAL DWGS. FOR ROOM AND CEILING HEIGHTS AND OFFSETS.

**NOTES**

- 1) PIPING SHALL BE 1/2\"/>
- 2) PIPING SHALL BE 1/2\"/>
- 3) ALL PIPING SHALL BE 1/2\"/>
- 4) PIPING SHALL BE 1/2\"/>
- 5) PIPING SHALL BE 1/2\"/>
- 6) PIPING SHALL BE 1/2\"/>
- 7) PIPING SHALL BE 1/2\"/>
- 8) PIPING SHALL BE 1/2\"/>
- 9) PIPING SHALL BE 1/2\"/>
- 10) PIPING SHALL BE 1/2\"/>
- 11) PIPING SHALL BE 1/2\"/>
- 12) PIPING SHALL BE 1/2\"/>
- 13) PIPING SHALL BE 1/2\"/>
- 14) PIPING SHALL BE 1/2\"/>
- 15) PIPING SHALL BE 1/2\"/>
- 16) PIPING SHALL BE 1/2\"/>
- 17) PIPING SHALL BE 1/2\"/>
- 18) PIPING SHALL BE 1/2\"/>
- 19) PIPING SHALL BE 1/2\"/>
- 20) PIPING SHALL BE 1/2\"/>

**LOWER LEVEL PLAN**  
 FIN. ELEV. 825.75 SCALE: 1/4\"/>

SYMBOL	DESCRIPTION	SUPPLY PIPING				DRAINAGE PIPING				REMARKS
		TYPE	SIZE	WALL	FLOOR	TYPE	SIZE	WALL	FLOOR	
A1	WATER CLOSET - WALL HUNG	1 1/2"	1"			4"	3"			SEE DWG.
A2	WATER CLOSET - W.H. - HANDICAPPED	2"	1 1/2"			4"	3"			SEE DWG.
B1	WATER CLOSET - 30" X 60"	2"	1 1/2"			4"	3"			W-521
C1	URINAL - WALL HUNG	3/4"	1"			2"	2"			W-522
D1	PUMP SINK - 24" X 24"	SUPPLY & 3/4"	1"			2"	2"			PRECAST RECEIVED BY P.C.
D2	SERVICE SINK	3/4"	1"			2"	2"			TRAP STANDARD
E1	WATER COOLER - WALL HUNG	3/4"	1"			2"	2"			W-523
M1	WET BATH UNIT					2"	2"			UNIT BY P.C. - SEE NOTE

INDICATES ITEMS OF EQUIPMENT FURNISHED COMPLETE WITH SUPPLY & WASTE TRIM AND SET IN PLACE BY THE A.C. - THE P.C. SHALL INSTALL ALL LOOSE FITS AND SHALL FURNISH AND INSTALL ALL STOPS, TRAPS, CONTINUOUS WASTE AND MAKE ALL FINAL CONNECTIONS.

SYMBOL	TYPE	BODY	STRAINER				OUTLET				REMARKS	
			TYPE	SIZE	WALL	FLOOR	TYPE	SIZE	WALL	FLOOR		
AD-1												SECURED WEATE
FD-1												6" X 6" BODY SIZE - W.H. INTERIOR
ED-1												ZEPHRA P-111
ED-2												W-527
ED-3												W-528
ED-4												W-529

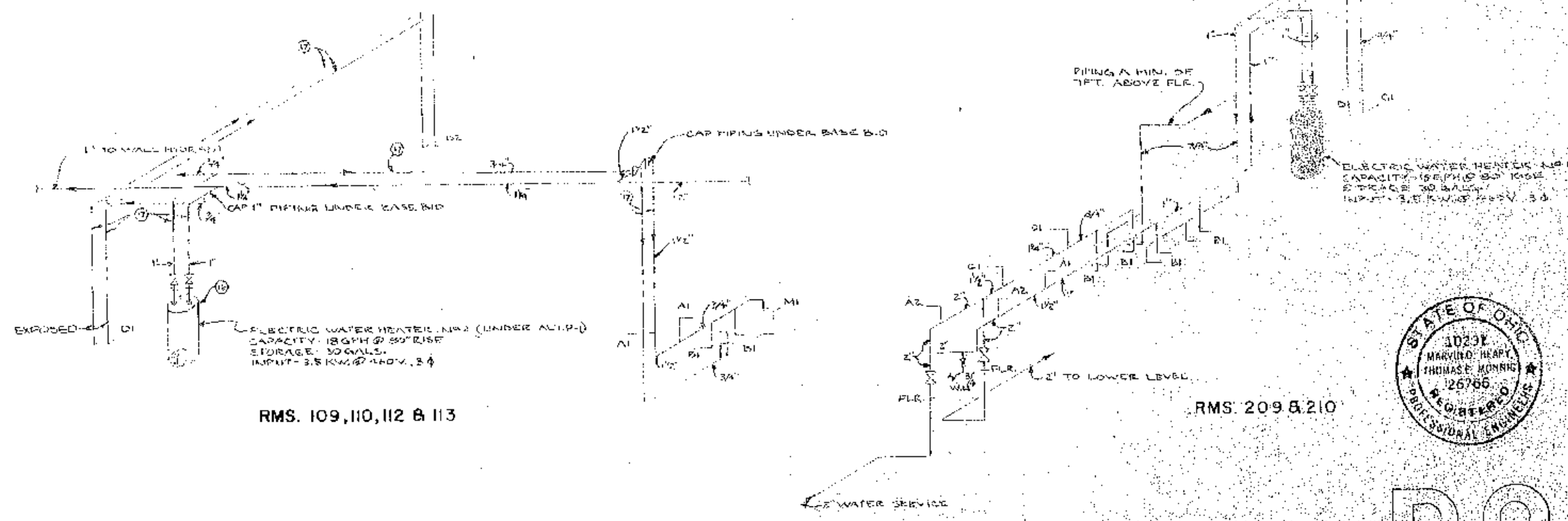

RMS. 109, 110, 112 & 113

RMS. 209 & 210

**SUPPLY PIPING**

**SHEET ATTACHED FOR REFERENCE ONLY**

RICHARD LEVIN ASSOCIATES INC. ARCHITECTS  
 24 NORTH JEFFERSON STREET DAYTON, OHIO 45402 513-224-1931

TROY-MIAMI COUNTY PUBLIC LIBRARY



**P2**



PRINTING

REVISIONS

PROJECT NO. 7294  
 DRAWN: [ ]  
 CHECKED: [ ]  
 APPROVED: [ ]  
 PRELIM. APPROVAL: [ ]  
 FINAL APPROVAL: [ ]  
 ISSUED: [ ]

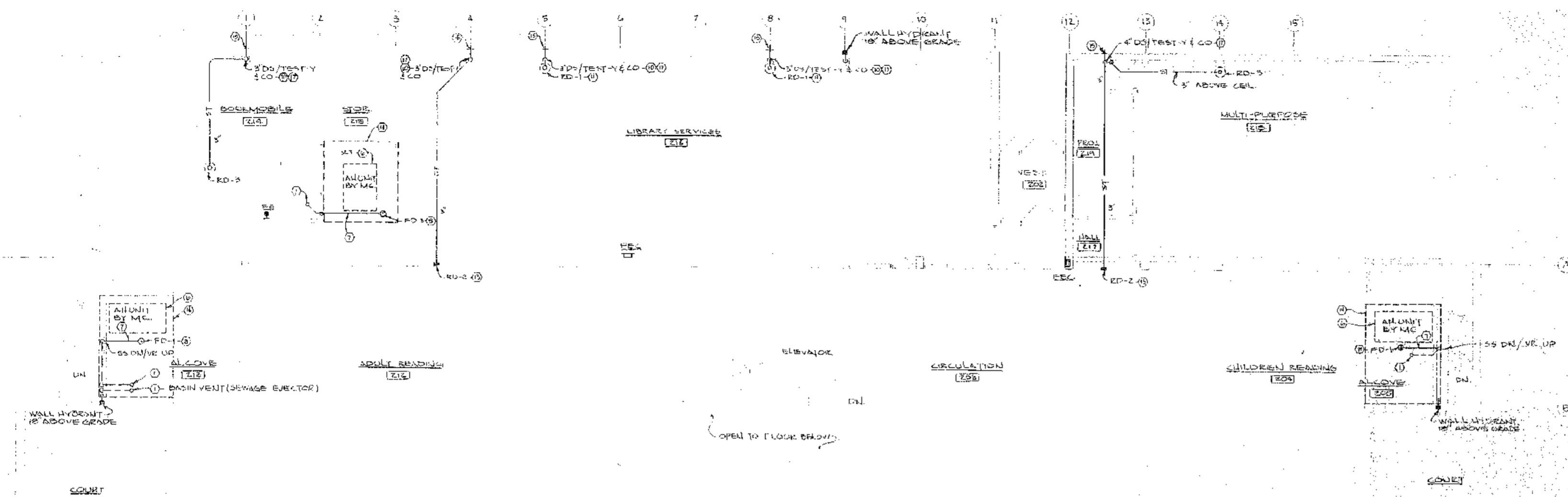

- NOTES**
- ① VENT THRU ROOF
  - ② PIPING IN CHASE NEAR FLOOR SLAB - SEE DIAGRAM
  - ③ SEE SUPPLY TRUNK DIAGRAM - SHEET 7
  - ④ PIPING CONT'D ON LOWER LEVEL FLOOR PLAN
  - ⑤ ELECTRIC POWER HERE - SEE DIAGRAM SHEET
  - ⑥ UNIT LOCATED IN MECH. EQUIP. ROOM ABOVE - VERIFY EXACT LOCATION WITH M.C.
  - ⑦ PREPARE UNDESIRED MECH. EQUIPMENT ROOM
  - ⑧ AIR LOUVER IN MECH. EQUIP. ROOM ABOVE - APPROPRIATE EXACT LOCATION WITH M.C.
  - ⑨ EXTEND VENT THRU WALL ABOVE MAIN FLOOR AND TURN UP - PROVIDE PLUMBING AS REQUIRED - SEE MECH. ELECTRICAL FOR WALL SECTION
  - ⑩ DOWNSPOUT IN MASONRY PLASTER - SEE ARCH. DETAIL ON SHEET 10 - TEST-Y & CO. NEXT FLOOR
  - ⑪ EXPANSION JOINT ON DOWNSPOUT ROOF DRAIN OUTLET - SEE MASONRY
  - ⑫ FUTURE AND/OR PIPING INDICATED UNDER SLAB - THIS SEE ARCH. & ELECTRICAL
  - ⑬ SEE ARCH. DETAIL ON SHEET 10
  - ⑭ OUTLINE OF MECH. EQUIPMENT ROOM ABOVE - REFER TO MECH. ELECTRICAL FOR ELEVATION AND DIMENSIONS
  - ⑮ UNDER BASE AND WALLS - STORE APPROX. 4" ABOVE FLOOR - WALLS APPROX. 4" FROM FACE OF WALL
  - ⑯ UNDER M.C. - EXTEND DOWNSPOUT TO GRADE - APPROX. 4" FROM FACE OF WALL - SEE ABOVE GRADE DETAIL - SEE SHEET 7

NO.	REVISION

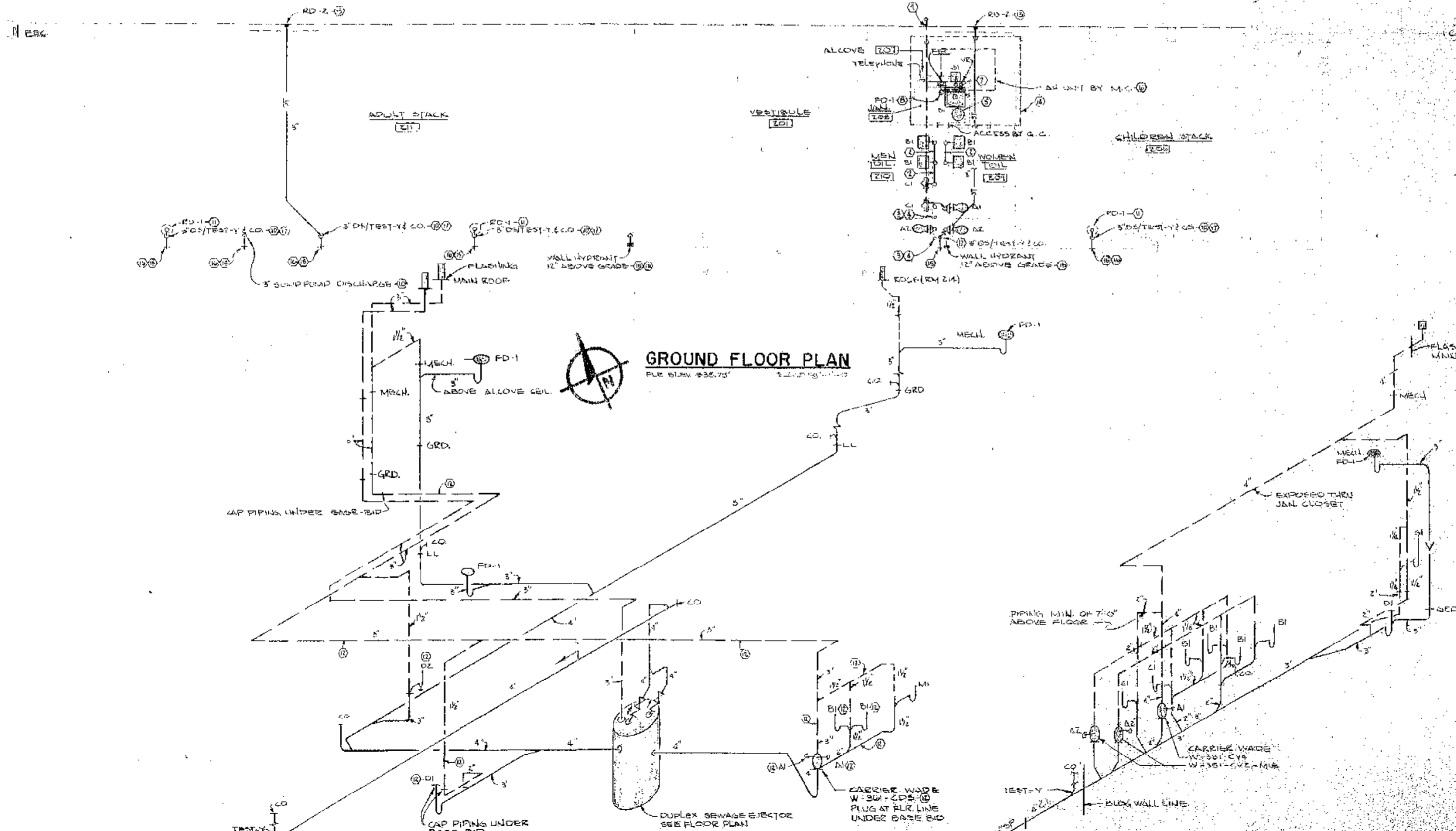

**GROUND FLOOR PLAN**  
PLR BLW 935.75'

**SOIL, WASTE & VENT**

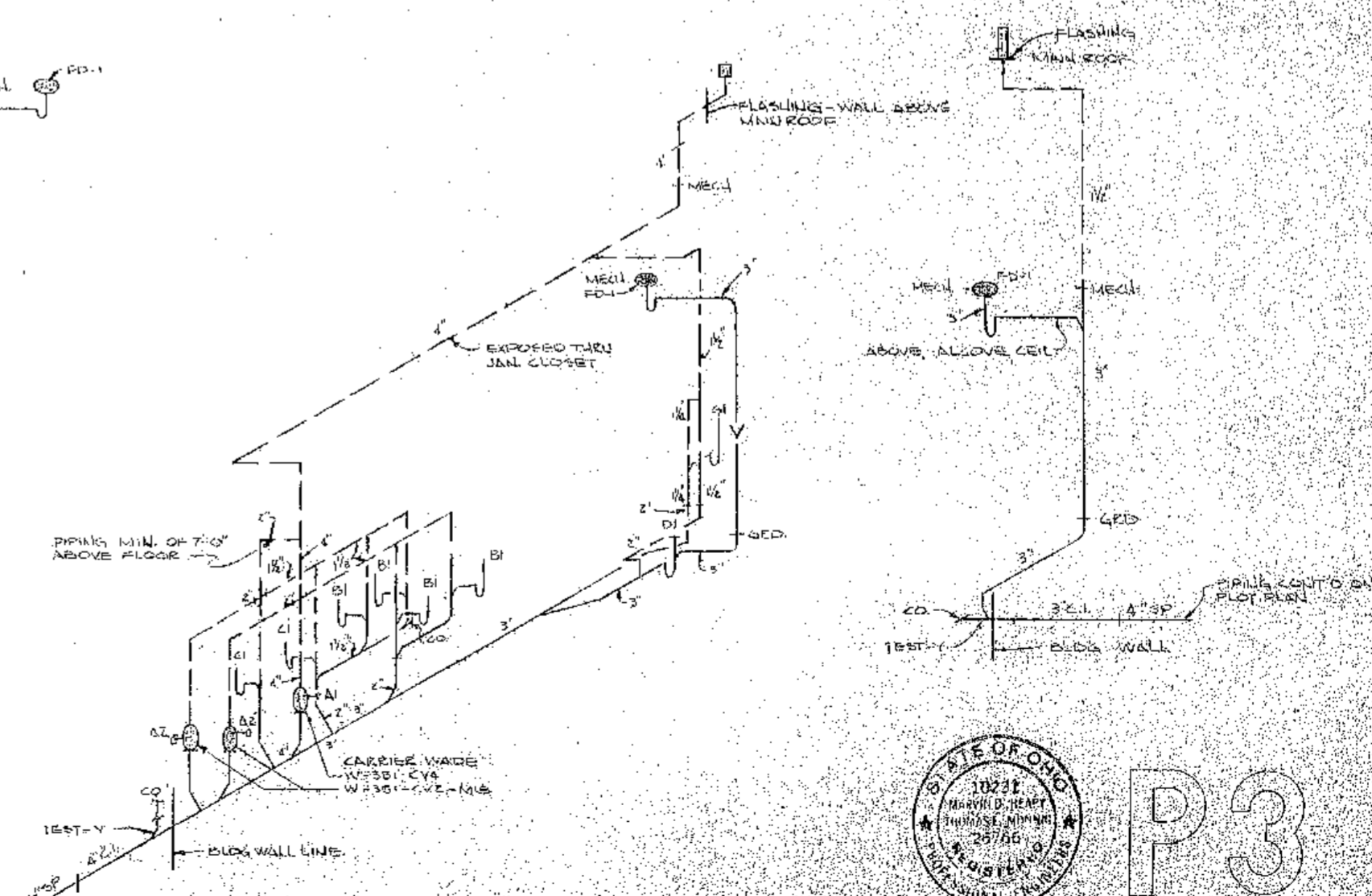

**SHEET ATTACHED FOR REFERENCE ONLY**



RICHARD LEVIN ASSOCIATES, INC. ARCHITECTS  
24 NORTH JEFFERSON STREET DAYTON, OHIO 45402 513-224-1931

PROJECT NO. 724-1

DRAWN  
CHECKED  
APPROVED  
PRELIM. APPROVAL  
FINAL APPROVAL  
ISSUED

TROY-MIAMI COUNTY PUBLIC LIBRARY

PRINTING

REVISIONS

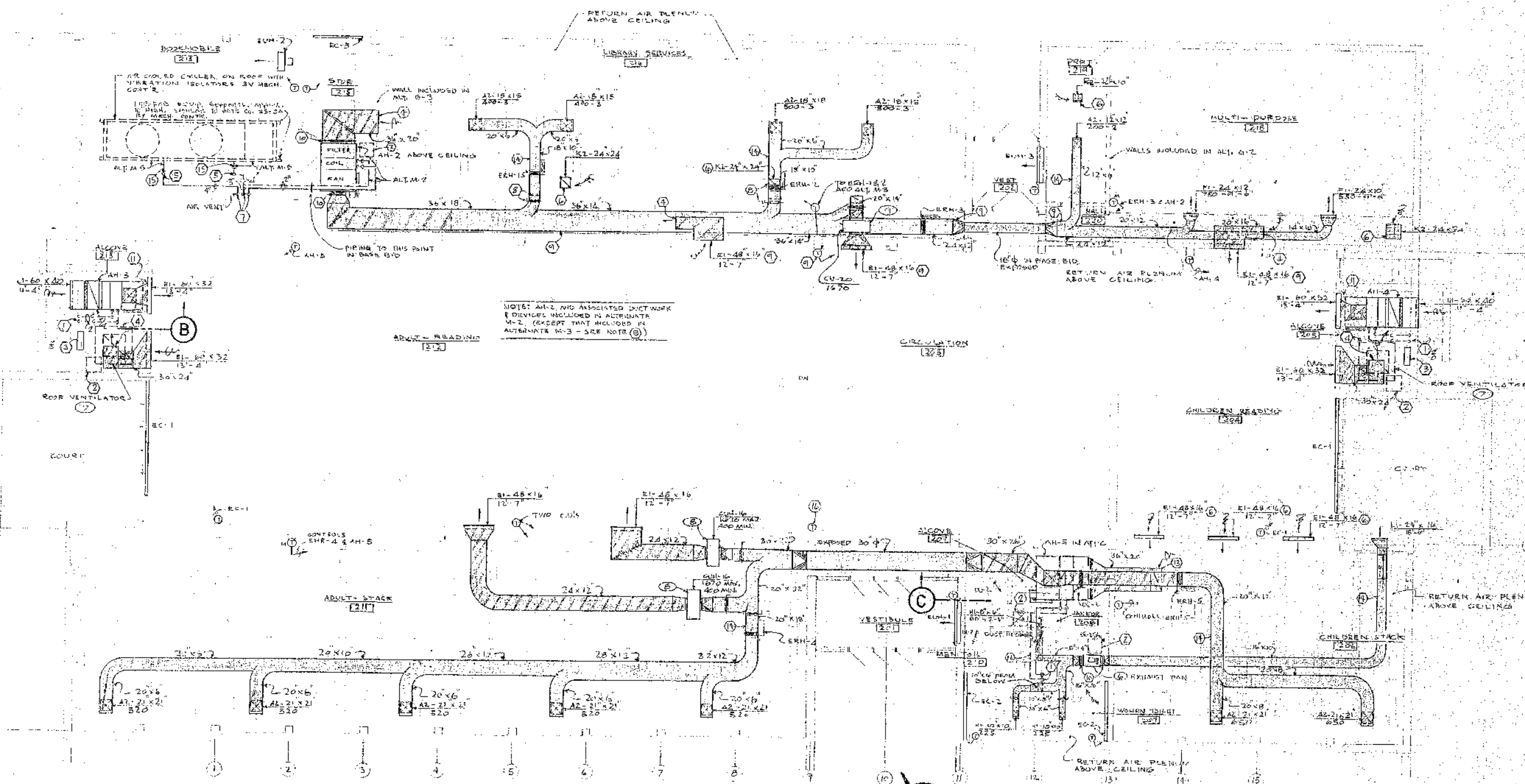

**NOTES**

- 1) CHILLED WATER PIPES DRAW IN CHASE AIR VENT ON ROOF SIDE
- 2) 24" DIA. ACCESS HOLES IN CEILING TO BECH. WORK
- 3) ELECTRIC HEATING COIL CONTROL PANEL
- 4) DUCT OPEN TO PLenum ABOVE CEILING
- 5) CHILLED WATER FROM ROOF THROUGH ROOF TO AIR COOLED CHILLER. PUMP & CONTROL BY LEVINE'S THROUGH ROOF. COILS ARE IN ROOF. 3" COILS INCLUDED IN INTERMEDIATE M-2. AIR FILTER OPEN TO PLenum ABOVE CEILING.
- 6) CHILLED WATER PIPES DROP EXPOSED AT WALLS IN BASE BLDG. (SEE TYPICAL DIAGRAM FOR COIL HEADS AND SILENT RUN VALVE)
- 7) STAIN & COY. DUCT WITH MANUAL GANGED IN ADD. AUTOMATIC M-2. COIL HEATING COIL & DISPOSED IN ROOF.
- 8) INCLUDED IN ALTERNATE M-1
- 9) FLEXIBLE CONNECTIONS
- 10) 4" DIA. DUCT CONNECTED TO REGISTER BLANK END REMAINS TO BE INSTALLED
- 11) KEEP PIPES HIGH ENOUGH TO FOLLOW ROOF PITCH
- 12) RETURN AIR DUCT EXPOSED TO AND OPEN TO PLenum ABOVE CEILING
- 13) DUCT TO BE DISPOSED ROOF TOP
- 14) RETURN AIR DUCT TYPE ON THIS PLAN (SEE TYPICAL DIAGRAM)
- 15) HIGH BURNING RATE (SEE M-2)

**EQUIPMENT DATA**

- 1) AIR COOL BY CHILLER. CAPACITY IN INTERMEDIATE M-2. CAPACITY 100 TONS. EXPOSED TO ROOF TOP. LEAN 3/4" TO 42" MAXIMUM PRESSURE DROP THROUGH EXPOSURE TO PLenum ABOVE CEILING.
- 2) CHILLED WATER CIRCULATING PUMP. (SEE TYPICAL DIAGRAM FOR PUMP HEAD & HEAD LOSS DATA)
- 3) EXPANSION TANK. (SEE TYPICAL DIAGRAM FOR SYSTEM CAPACITY & MAX. PRESSURE)
- 4) AIR CONTROL FITTING WITH AIR INLET VALVE
- 5) VALVE NORMALLY OPEN. HANDLE TO VALVE
- 6) 3/4" DRAIN VALVE. EXTEND DISCHARGE TO ROOF DRAIN
- 7) AUTOMATIC WATER MAKEUP ASSEMBLY. CHILLED WATER MAKEUP ASSEMBLY. UNION PRESSURE REGULATOR VALVE & AIR FILTER IN LINE. AND VALVE. SAFETY RELIEF VALVE TO BECOME FROM PRESSURE GAUGE AND BYPASS VALVE
- 8) FLOW SWITCH
- 9) EXHAUST FAN. (SEE TYPICAL DIAGRAM FOR FAN CURVE & STATIC PRESSURE)
- 10) ROOF VENTILATOR. (SEE TYPICAL DIAGRAM FOR PRESSURE, WIND LOAD, OPENING, etc.)
- 11) SAFETY DAMPER IN CURB BY PRESSURE CONTROL. (SEE TYPICAL DIAGRAM)
- 12) HIGH VELOCITY TYPE. (SEE TYPICAL DIAGRAM)
- 13) LOW VELOCITY TYPE. (SEE TYPICAL DIAGRAM)

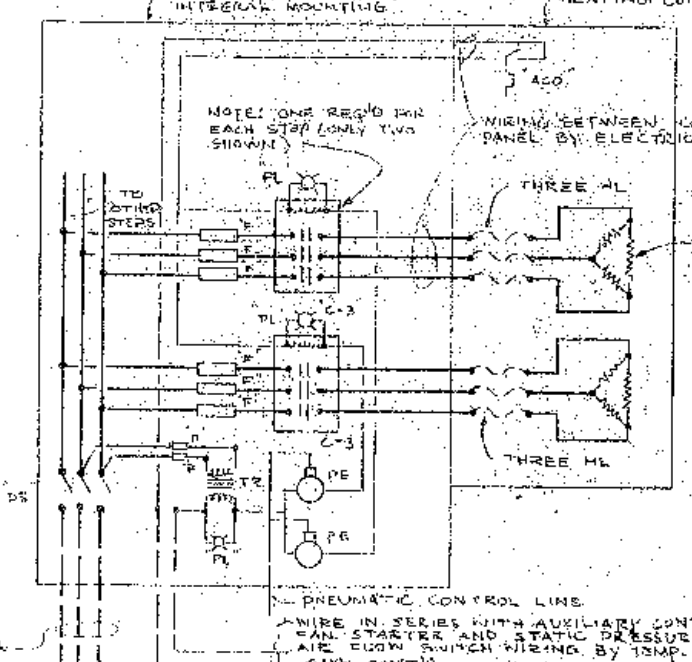
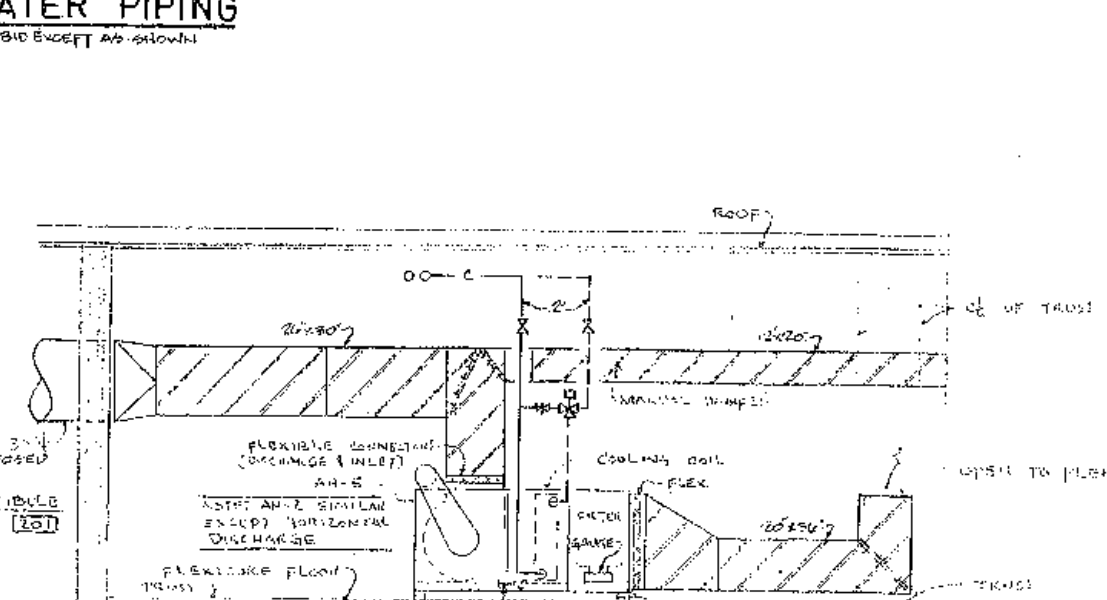
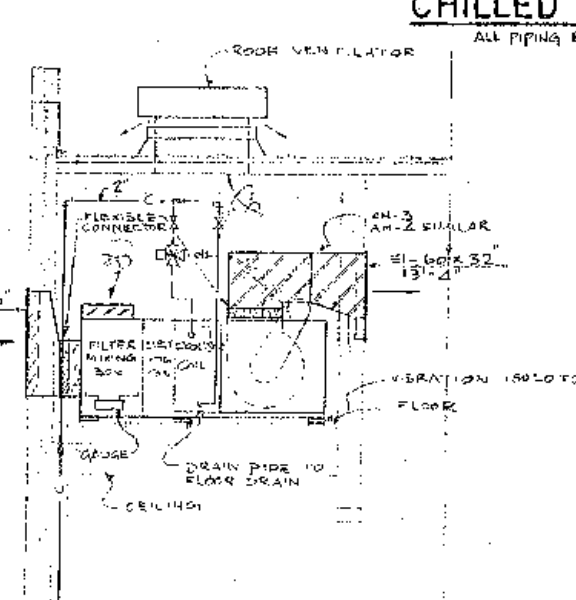
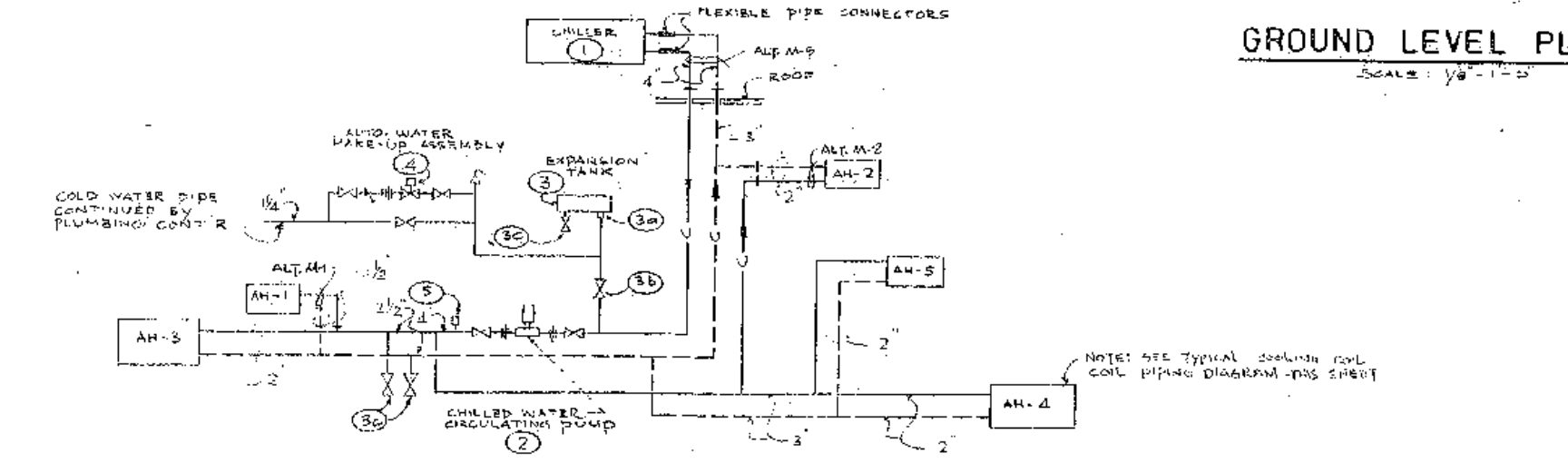

- LEGEND**
- AG - AUTOMATIC RESET HIGH TEMPERATURE CUT-OFF
  - C-3 - THREE-POLE SPEED CONTRACTOR
  - D-5 - SAFETY DISCONNECT SWITCH BUILT INTO DOOR
  - F - FUSE CARTRIDGE TYPE
  - HL - MANUAL RESETTABLE HEAT LIMITERS
  - P - PILOT LIGHT FLUSH MOUNTED ON CONTROL PANEL DOOR
  - PR - THERMATIC-ELECTRIC SWITCH BY TEMPERATURE CONTROL SUB-CONTROL - ONE FOR EACH STOP (NOT SHOWN)
  - TR - TRANSFORMERS
- FACTORY WIRING (solid line)  
FIELD WIRING (dashed line)  
POWER (thick line)CONTROL (thin line)
- \* ALL FIELD WIRING BY ELECTRICAL CONTRACTOR UNLESS OTHERWISE NOTED. DEVIATIONS FROM FIELD WIRING TO BE RESPONSIBILITY OF MECHANICAL CONTRACTOR.

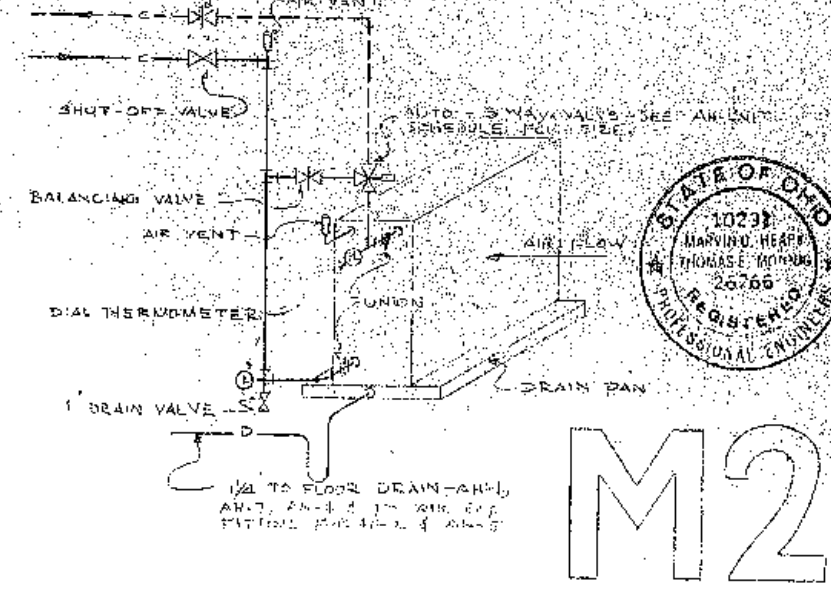

PROJECT NO. 7274  
 DRAWN: [blank]  
 CHECKED: [blank]  
 APPROVED: [blank]  
 PRELIM. APPROVAL: [blank]  
 FINAL APPROVAL: [blank]  
 REVISIONS: [table with 10 rows and 2 columns]  
 PRINTING: [blank]  
 REVISIONS: [blank]

RICHARD LEVIN ASSOCIATES, INC. ARCHITECTS  
 24 NORTH JEFFERSON STREET DAYTON, OHIO 45402 513-274-1991  
 TROY-ARLHAM COUNTY DEPT. OF HEALTH

STATE OF OHIO  
 10231  
 MARVIN HENRY  
 THOMAS WILSON  
 26766  
 REGISTERED  
 PROFESSIONAL ENGINEERS

**M2**  
 SHEET ATTACHED FOR REFERENCE ONLY